

# TECHNICAL DETAILS

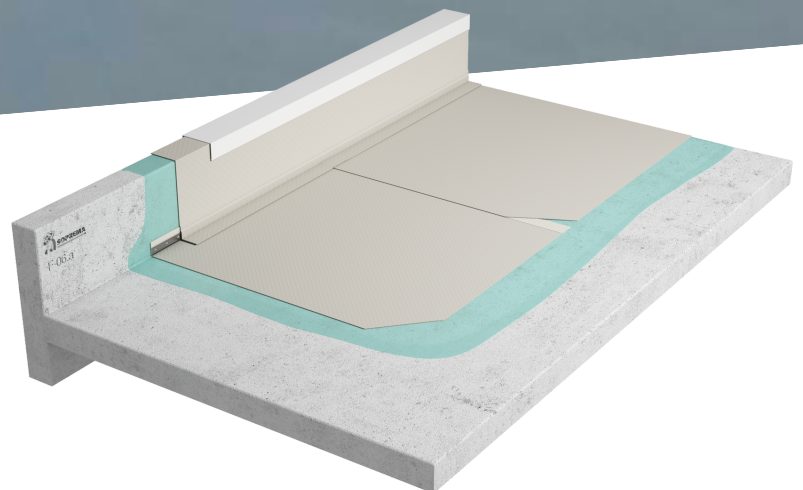

Synthetic Roofs  
**FLAGON SFC**

[soprema.com.au](http://soprema.com.au)

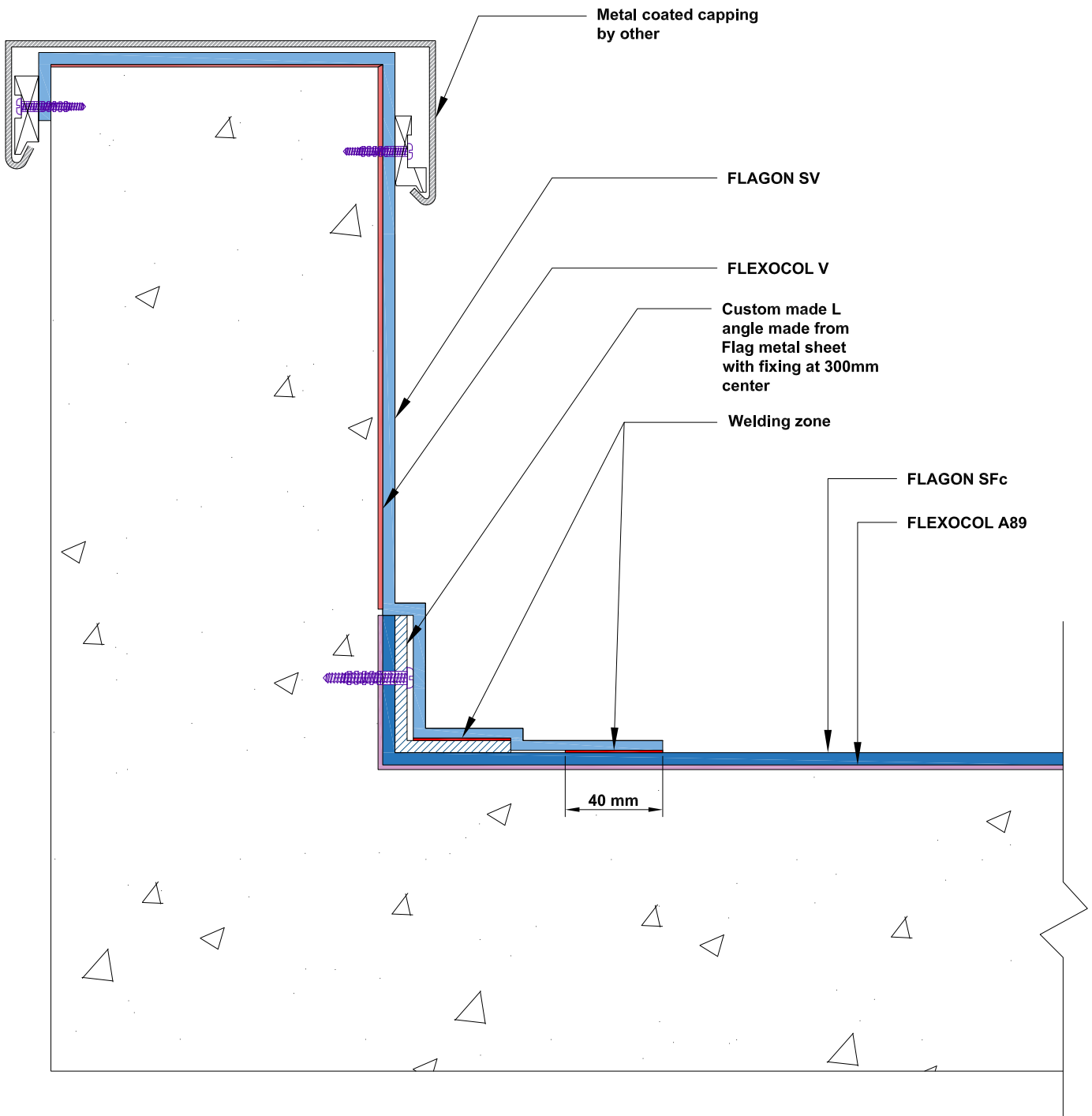

COPYRIGHT 2021 SOPREMA



LEVEL 35, BARANGAROO AVENUE, SYDNEY, 2000  
WWW.SOPREMA.COM.AU

TITLE:		PERIMETER DETAIL WITH METAL CAPPING	
PROJECT:		DRAWING NUMBER:	
SCALE:	NTS	DATE:	2021
			SFC1

**NOTE:**  
This detail is only indicative and should be verified by the designer and/or the applicator according to real job site conditions.

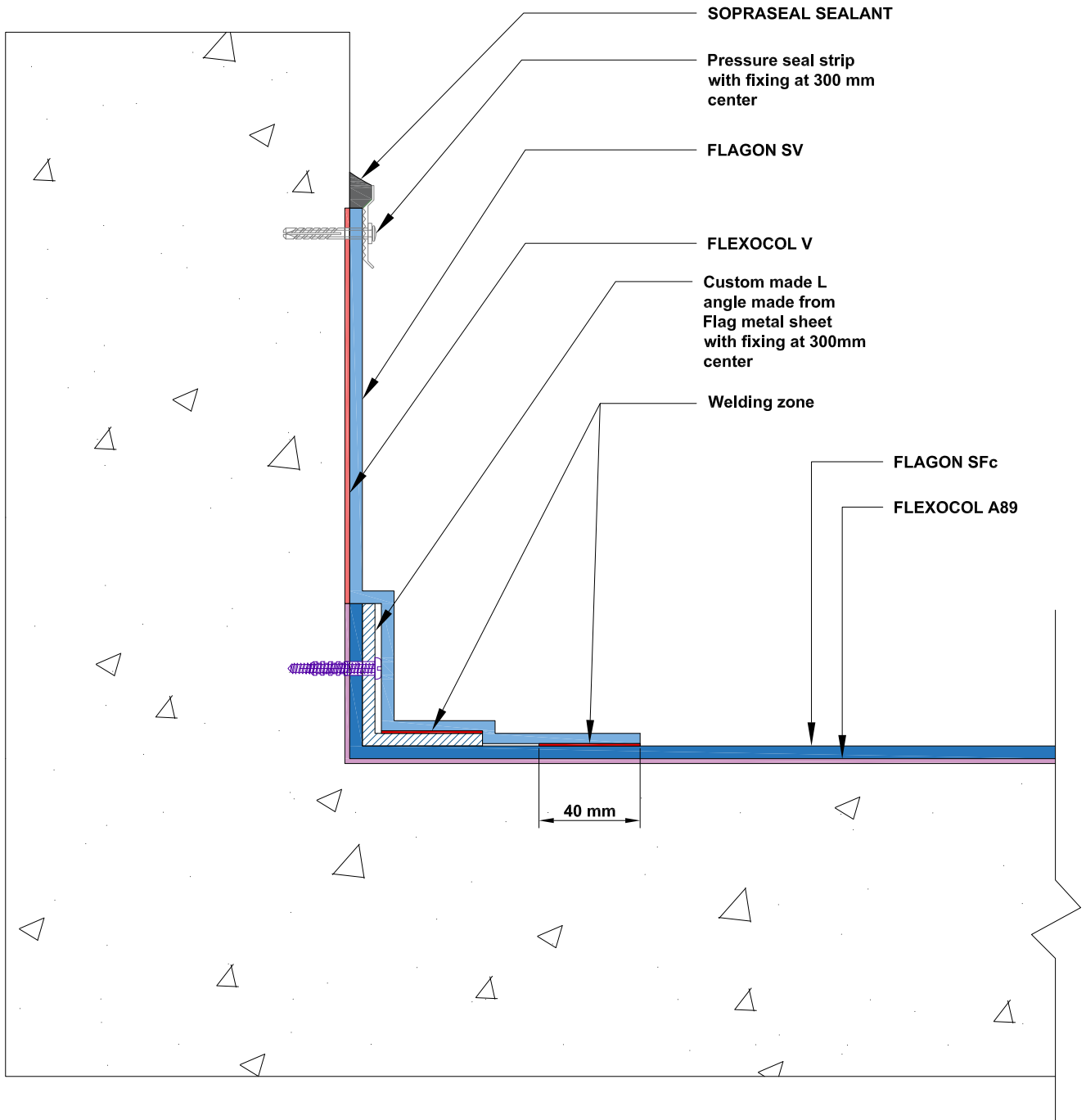

COPYRIGHT 2021 SOPREMA



LEVEL 35, BARANGAROO AVENUE, SYDNEY, 2000  
WWW.SOPREMA.COM.AU

TITLE:		PERIMETER DETAIL WITH PRESSURE SEAL STRIP	
PROJECT:		DRAWING NUMBER:	
SCALE:	NTS	DATE:	2021
			SFC2

**NOTE:**

This detail is only indicative and should be verified by the designer and/or the applicator according to real job site conditions.

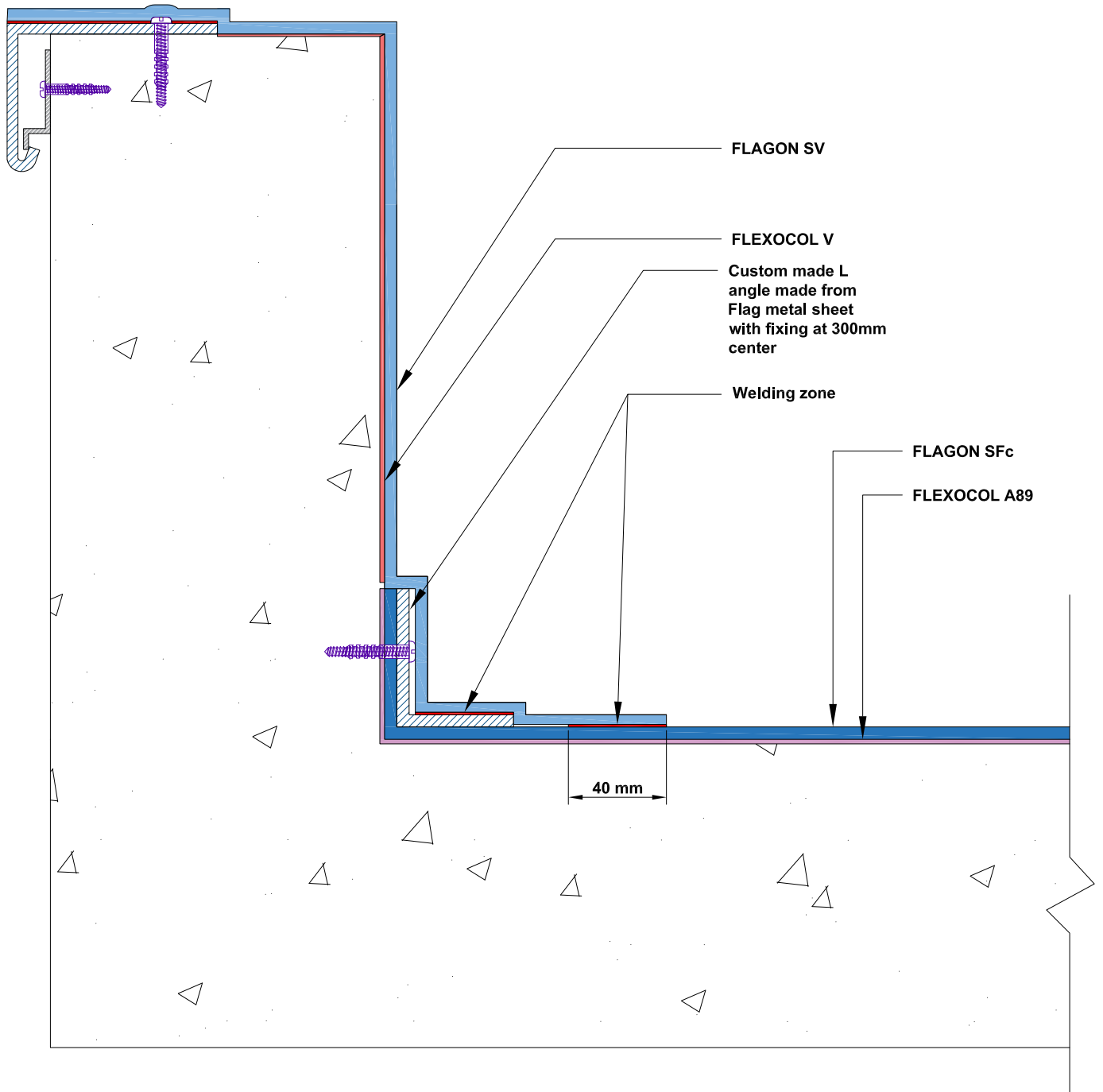

COPYRIGHT 2021 SOPREMA



LEVEL 35, BARANGAROO  
 AVENUE, SYDNEY, 2000  
 WWW.SOPREMA.COM.AU

TITLE:		PERIMETER DETAIL WITH ROOF EDGE	
PROJECT:		DRAWING NUMBER:	
SCALE:	NTS	DATE:	2021
			SFC3

**NOTE:**  
 This detail is only indicative and should be verified by the designer and/or the applicator according to real job site conditions.

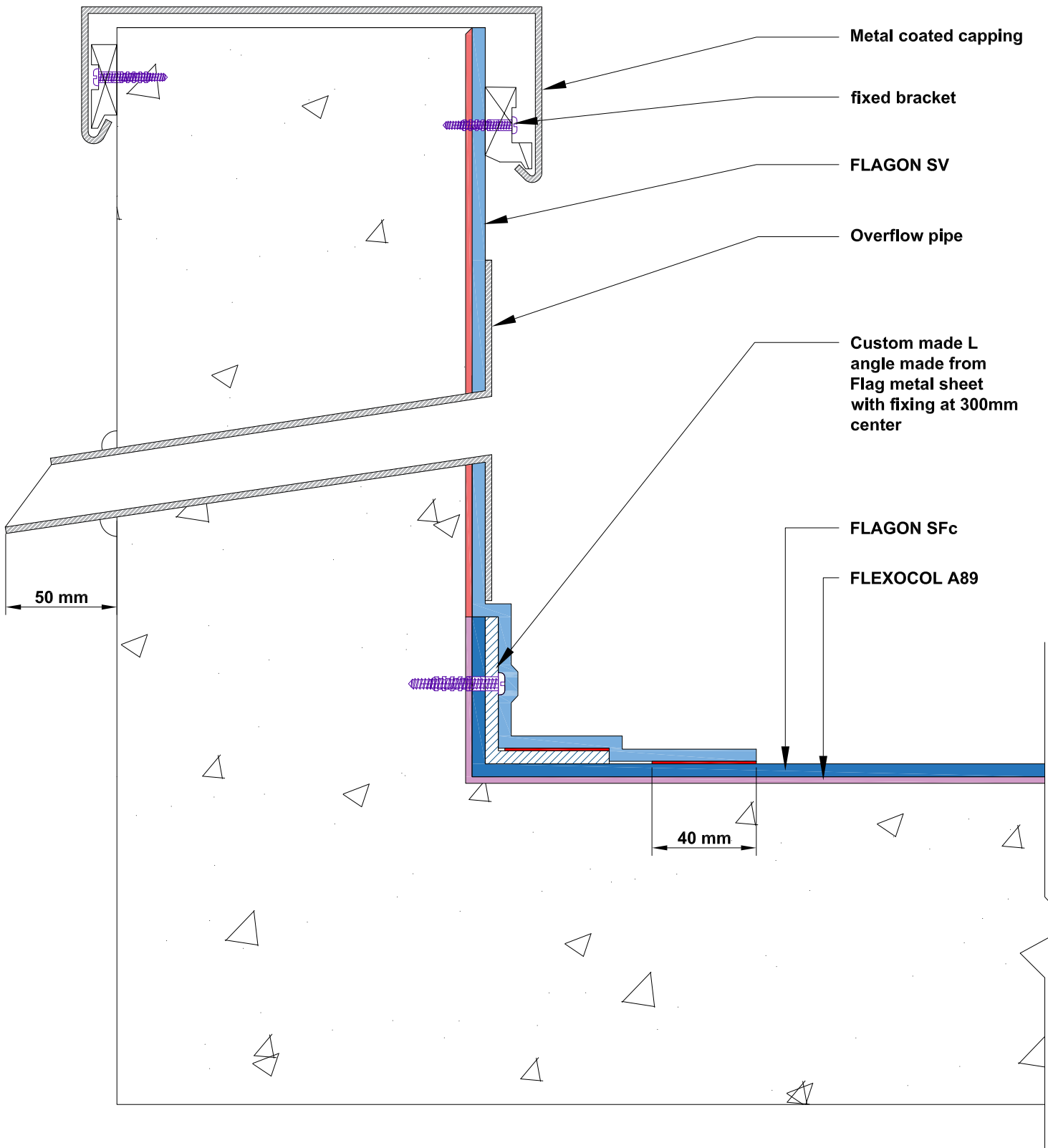

Metal coated capping

fixed bracket

FLAGON SV

Overflow pipe

Custom made L angle made from Flag metal sheet with fixing at 300mm center

FLAGON SFc

FLEXOCOL A89

50 mm

40 mm

COPYRIGHT 2021 SOPREMA



LEVEL 35, BARANGAROO AVENUE, SYDNEY, 2000  
WWW.SOPREMA.COM.AU

TITLE: PERIMETER DETAIL AT THE OVER FLOW

PROJECT: DRAWING NUMBER:

SCALE: NTS DATE: 2021 SFC4

**NOTE:**  
This detail is only indicative and should be verified by the designer and/or the applicator according to real job site conditions.

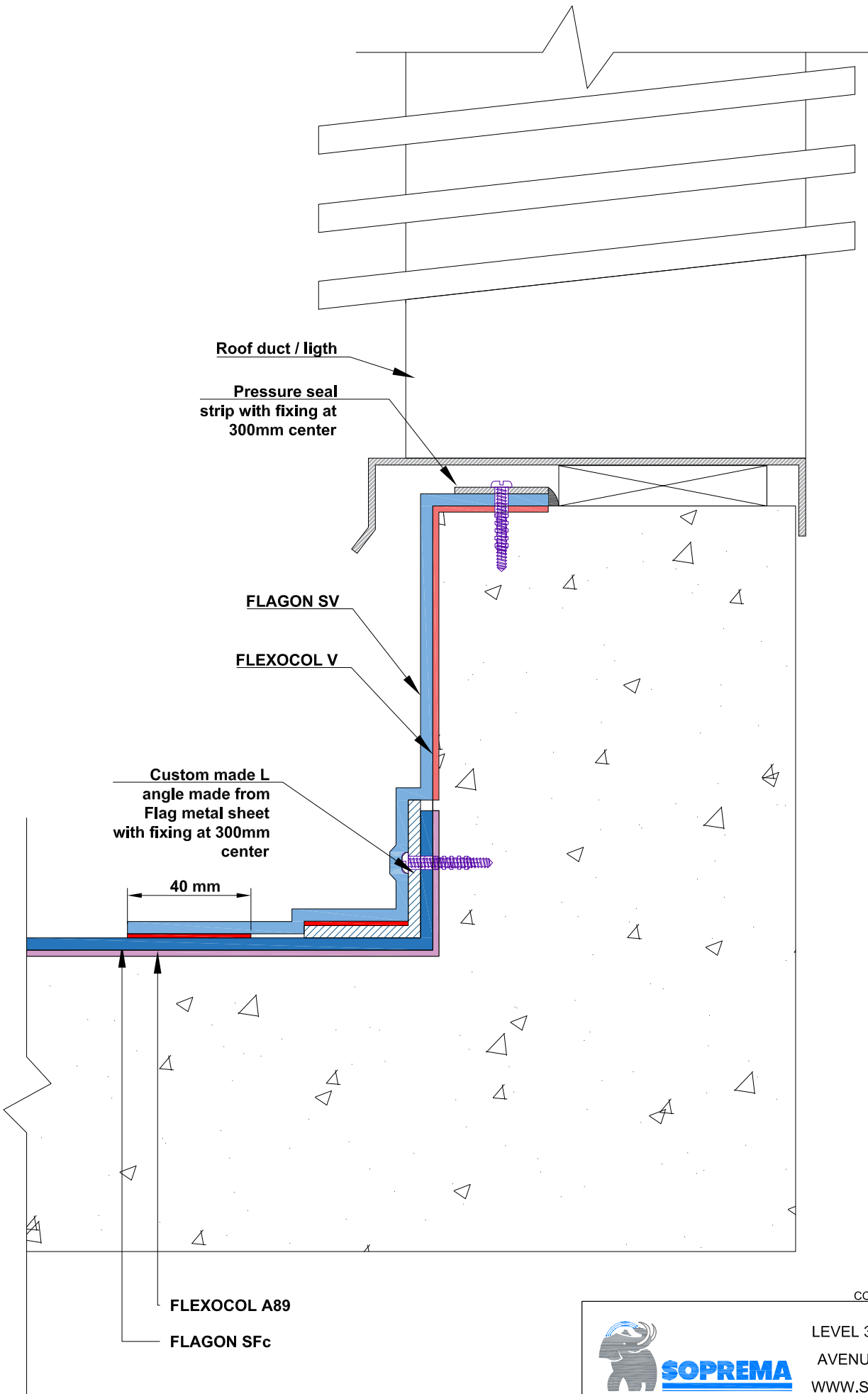

COPYRIGHT 2021 SOPREMA



LEVEL 35, BARANGAROO AVENUE, SYDNEY, 2000  
 WWW.SOPREMA.COM.AU

TITLE:		ROOF DUCT / LIGHT DETAIL	
PROJECT:		DRAWING NUMBER:	
SCALE:	NTS	DATE:	2021
			SFC6

**NOTE:**  
 This detail is only indicative and should be verified by the designer and/or the applicator according to real job site conditions.

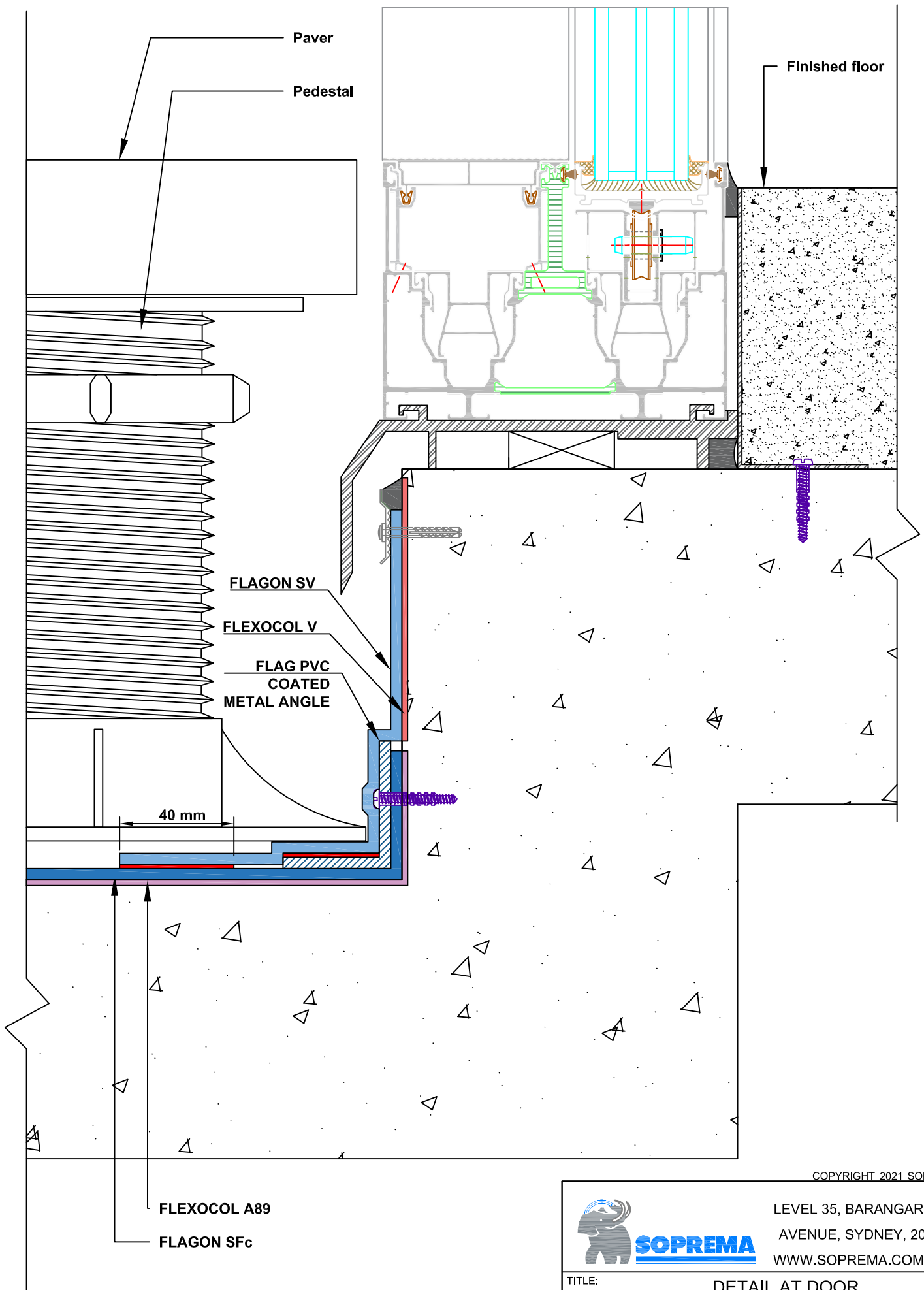

COPYRIGHT 2021 SOPREMA

FLEXOCOL A89  
FLAGON SFc



**SOPREMA**

LEVEL 35, BARANGAROO AVENUE, SYDNEY, 2000  
WWW.SOPREMA.COM.AU

TITLE:		DETAIL AT DOOR	
PROJECT:		DRAWING NUMBER:	
SCALE:	NTS	DATE:	2021
			SFC7

**NOTE:**  
This detail is only indicative and should be verified by the designer and/or the applicator according to real job site conditions.

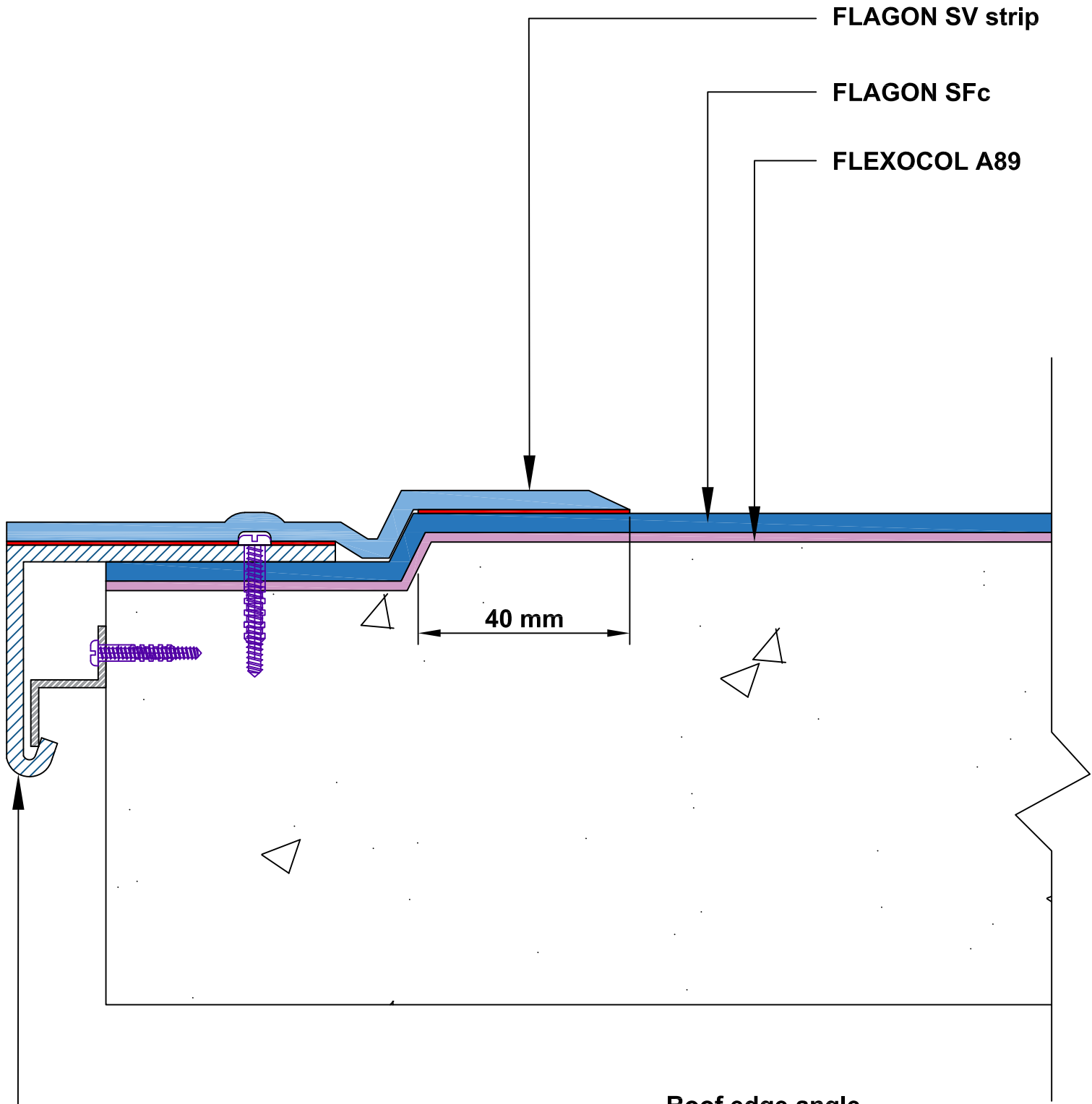

FLAGON SV strip

FLAGON SFc

FLEXOCOL A89

40 mm

Roof edge angle  
with fixings at 300 mm center

COPYRIGHT 2021 SOPREMA



LEVEL 35, BARANGAROO AVENUE, SYDNEY, 2000  
WWW.SOPREMA.COM.AU

TITLE:		PERIMETER DETAIL ROOF EDGE WITHOUT HOB	
PROJECT:		DRAWING NUMBER:	
SCALE:	NTS	DATE:	2021
		SFC8	

**NOTE:**  
This detail is only indicative and should be verified by the designer and/or the applicator according to real job site conditions.



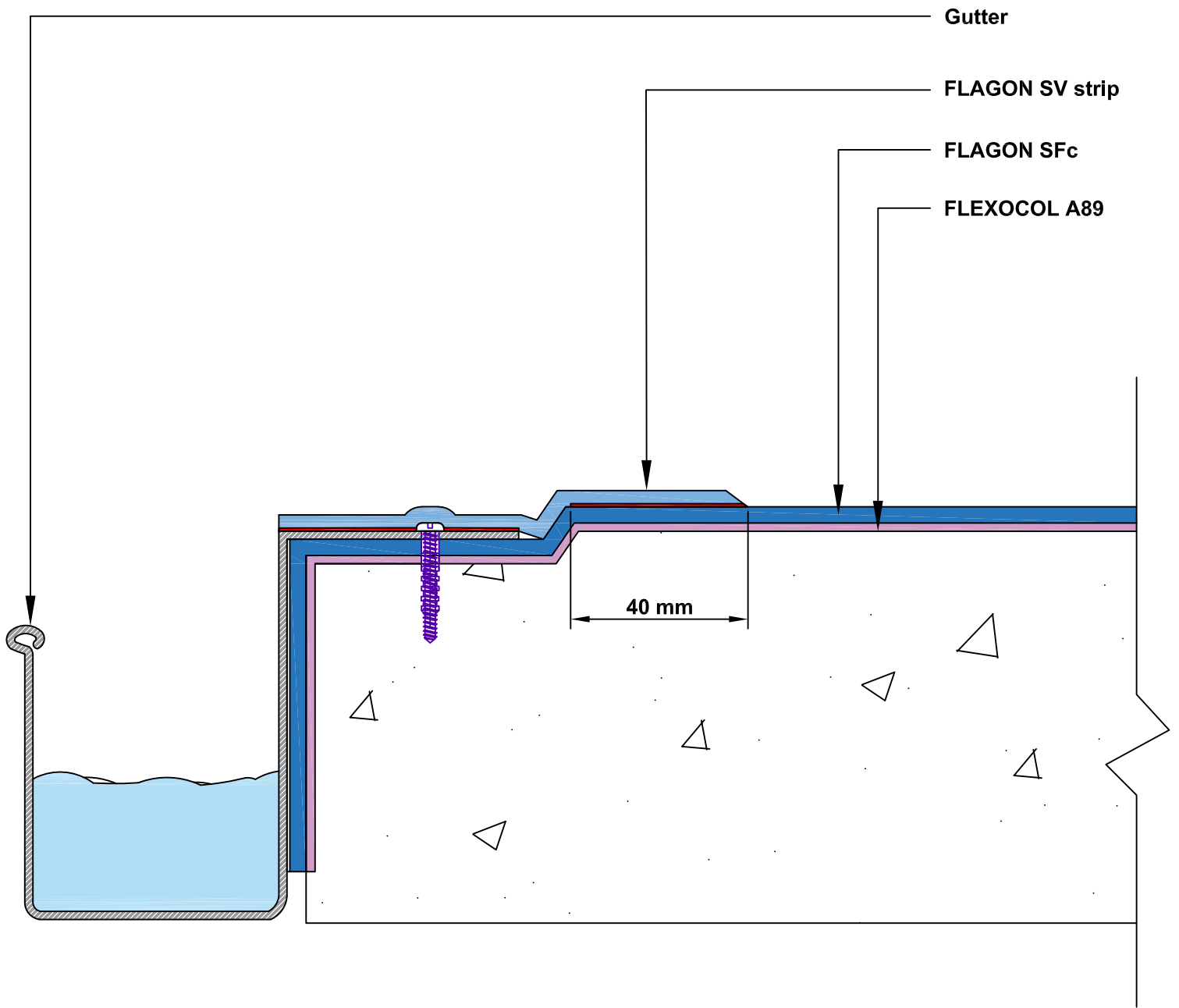

COPYRIGHT 2021 SOPREMA



LEVEL 35, BARANGAROO AVENUE, SYDNEY, 2000  
 WWW.SOPREMA.COM.AU

TITLE: PERIMETER DETAIL WITHOUT HOB TERMINATED INTO GUTTER

PROJECT:		DRAWING NUMBER:	
SCALE:	NTS	DATE:	2021
			SFC9

**NOTE:**  
 This detail is only indicative and should be verified by the designer and/or the applicator according to real job site conditions.

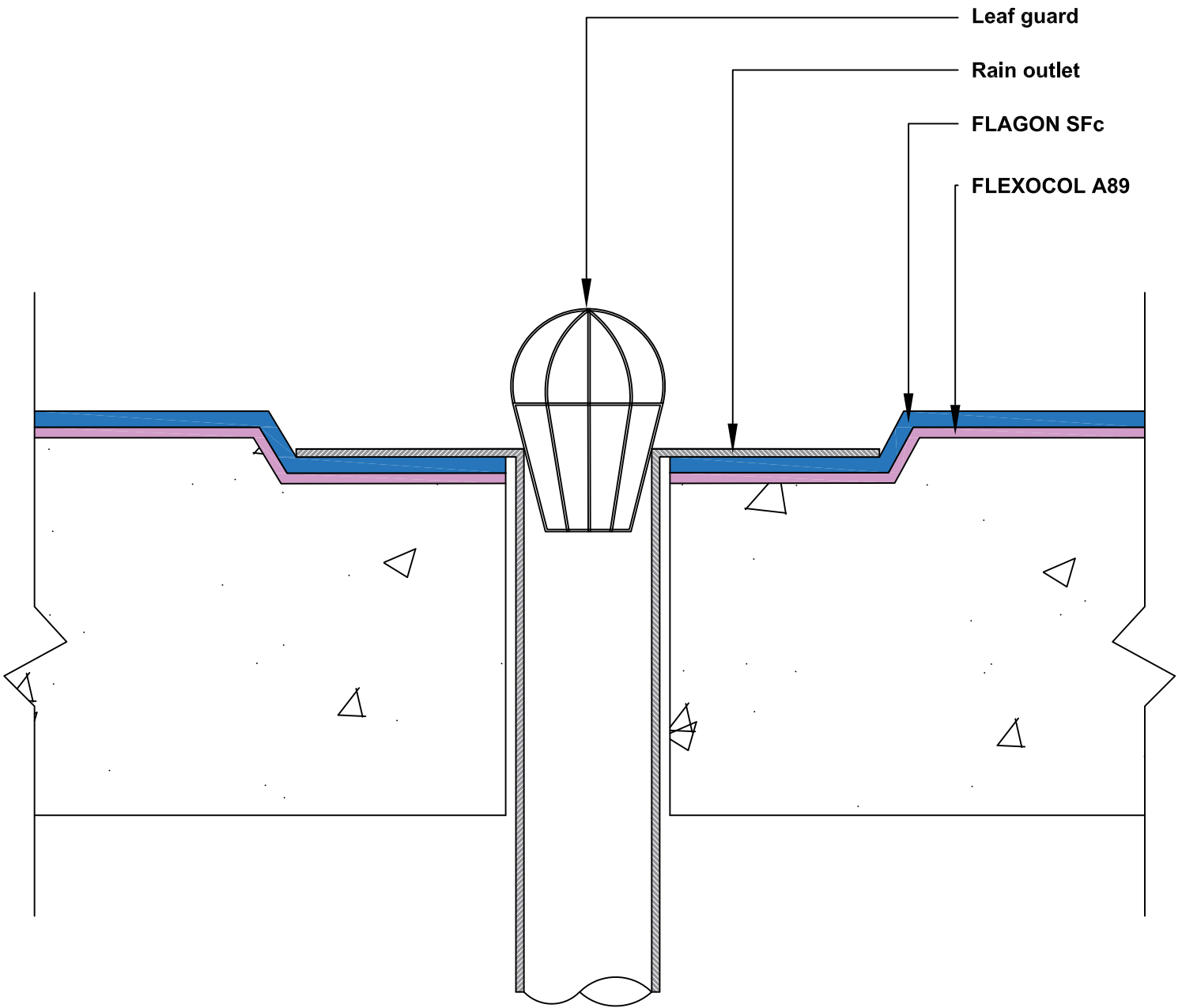

Leaf guard  
 Rain outlet  
 FLAGON SFc  
 FLEXOCOL A89

COPYRIGHT 2021 SOPREMA



LEVEL 35, BARANGAROO AVENUE, SYDNEY, 2000  
 WWW.SOPREMA.COM.AU

TITLE: VERTICAL RAIN OUTLET DETAIL

PROJECT:		DRAWING NUMBER:	
SCALE:	NTS	DATE:	2021
			SFC10

**NOTE:**  
 This detail is only indicative and should be verified by the designer and/or the applicator according to real job site conditions.

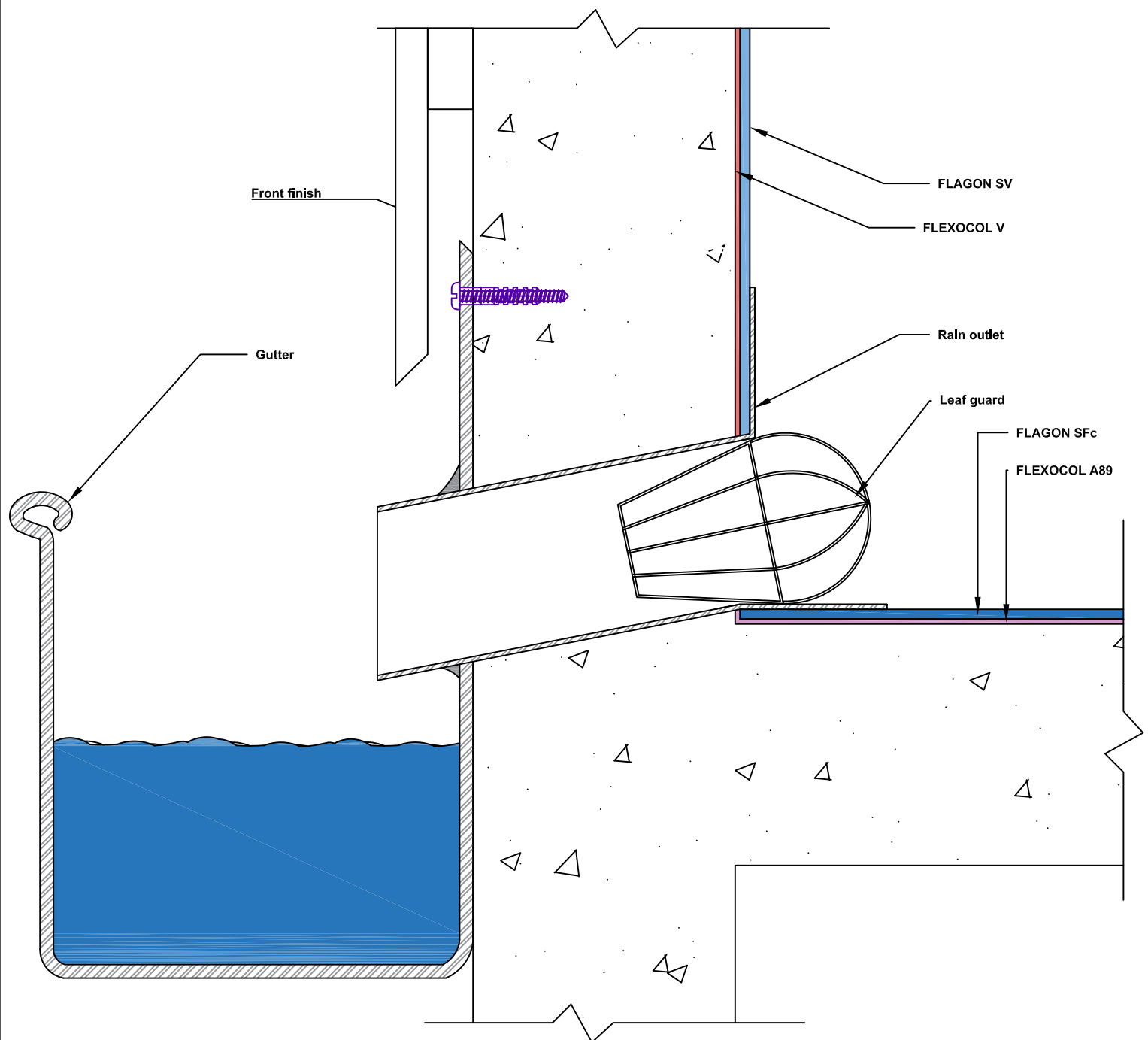

Front finish

Gutter

FLAGON SV

FLEXOCOL V

Rain outlet

Leaf guard

FLAGON SFc

FLEXOCOL A89

COPYRIGHT 2021 SOPREMA



LEVEL 35, BARANGAROO AVENUE, SYDNEY, 2000  
WWW.SOPREMA.COM.AU

TITLE: PERIMETER DETAIL AT HORIZONTAL RAIN OUTLET

PROJECT:		DRAWING NUMBER:	
SCALE:	NTS	DATE:	2021
			SFC5

**NOTE:**  
This detail is only indicative and should be verified by the designer and/or the applicator according to real job site conditions.

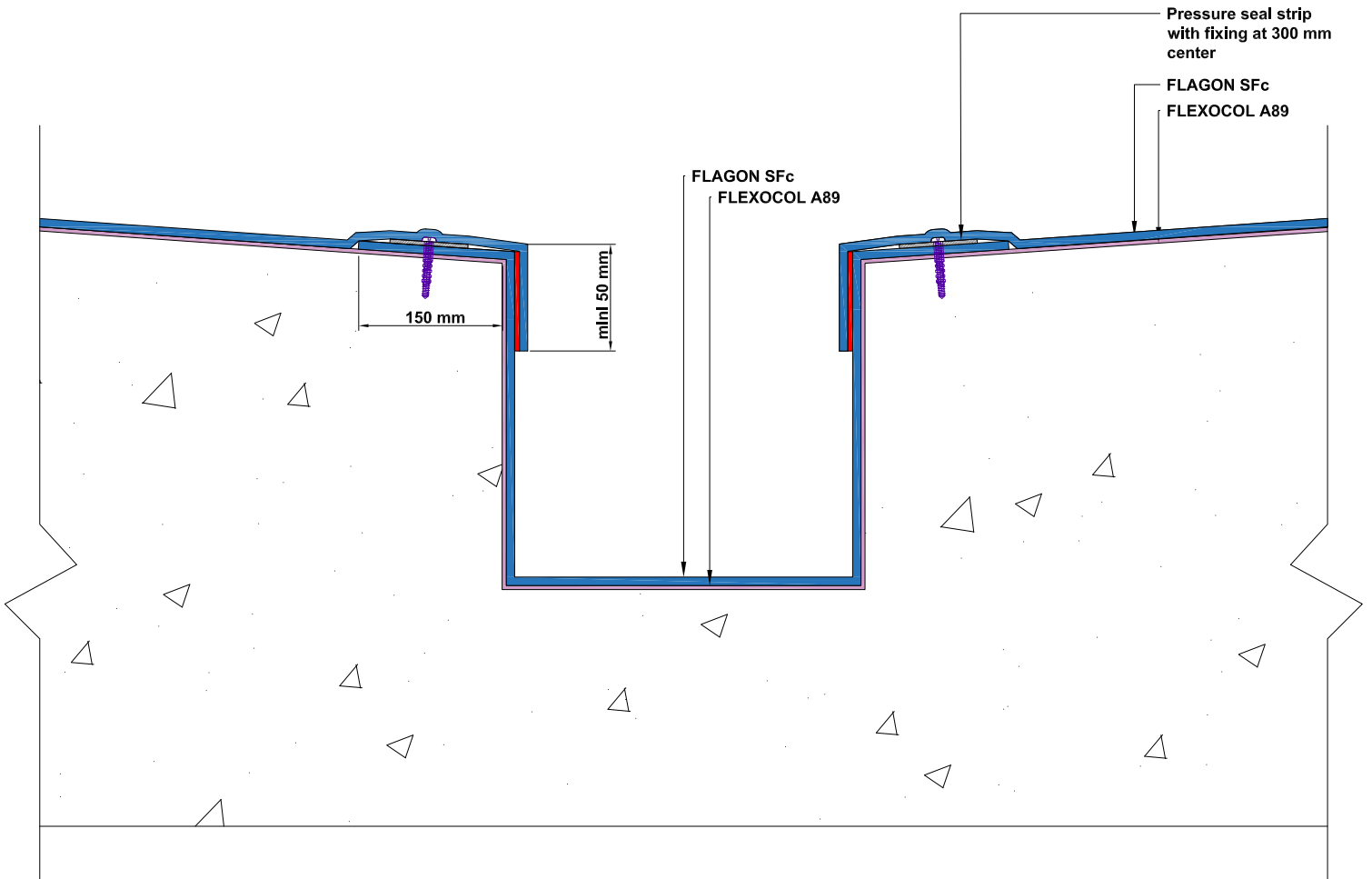

COPYRIGHT 2021 SOPREMA



LEVEL 35, BARANGAROO  
AVENUE, SYDNEY, 2000  
WWW.SOPREMA.COM.AU

TITLE:		VALLEY GUTTER DETAIL	
PROJECT:		DRAWING NUMBER:	
SCALE:	NTS	DATE:	2021
			SFC11

**NOTE:**  
This detail is only indicative and should be verified by the designer and/or the applicator according to real job site conditions.

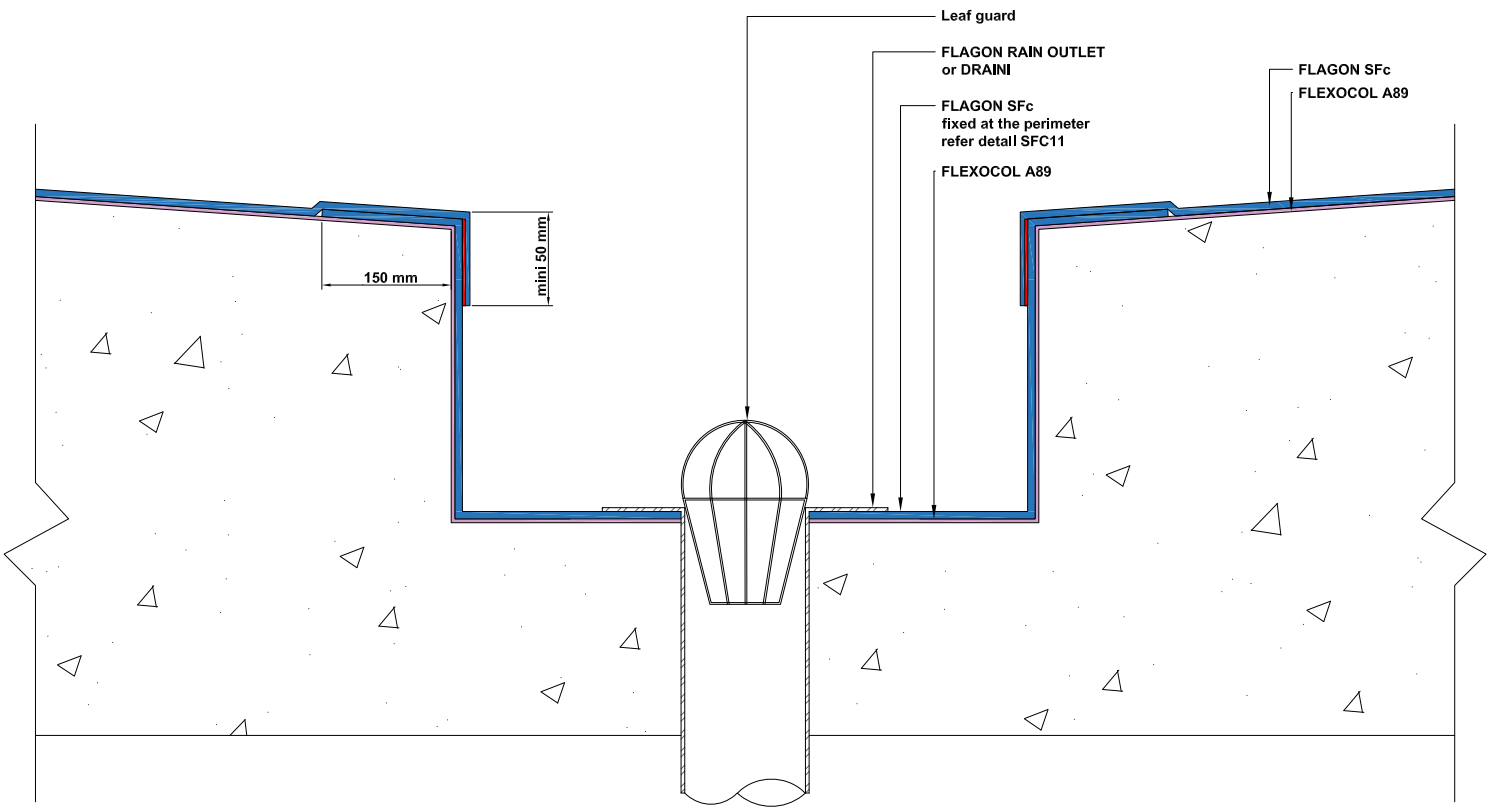

COPYRIGHT 2021 SOPREMA



LEVEL 35, BARANGAROO AVENUE, SYDNEY, 2000  
WWW.SOPREMA.COM.AU

TITLE:		VALLEY GUTTER DETAIL AT RAIN OUTLET	
PROJECT:		DRAWING NUMBER:	
SCALE:	NTS	DATE:	2021
			SFC12

**NOTE:**  
This detail is only indicative and should be verified by the designer and/or the applicator according to real job site conditions.

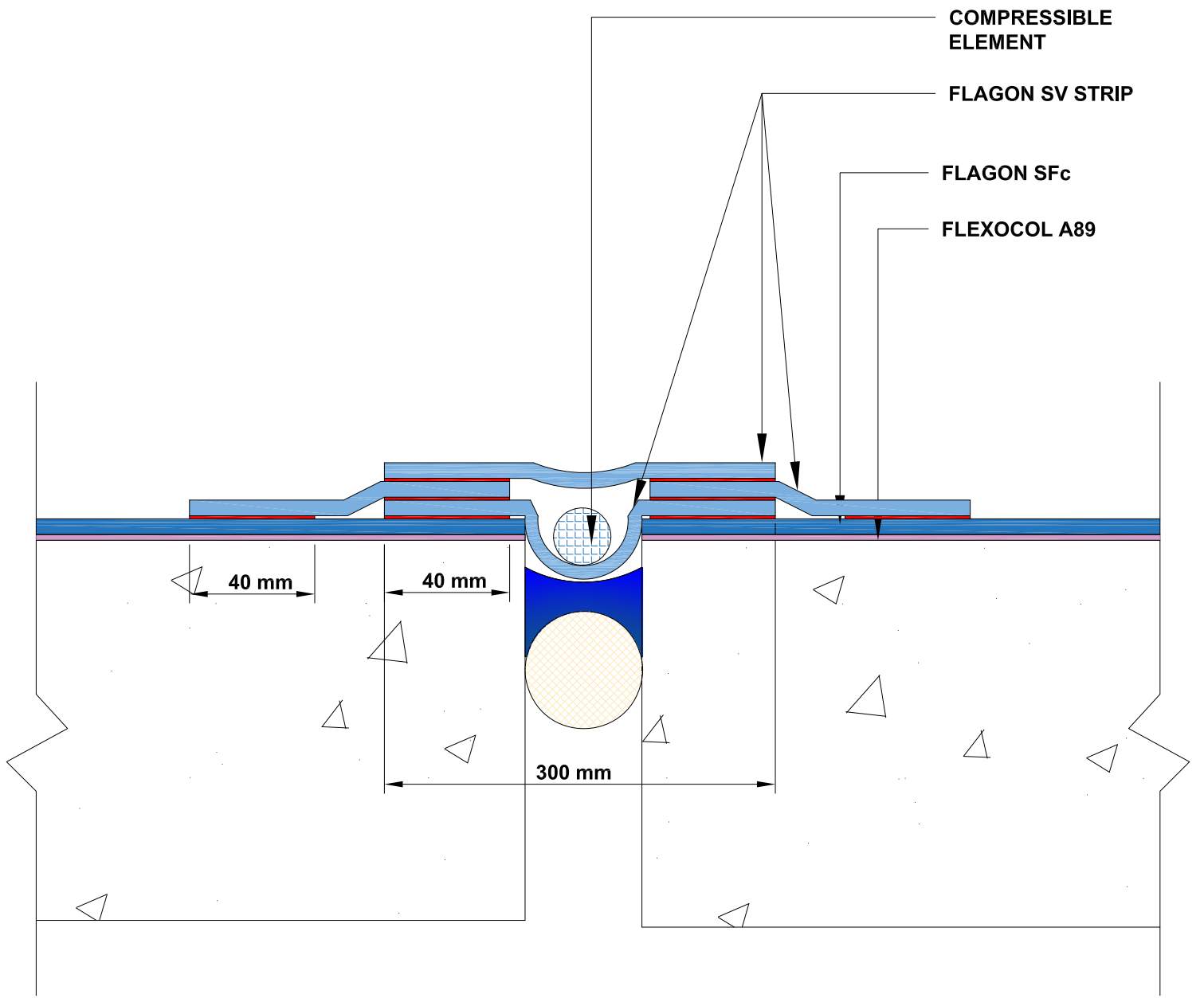

COMPRESSIBLE  
ELEMENT

FLAGON SV STRIP

FLAGON SFc

FLEXOCOL A89

40 mm

40 mm

300 mm

COPYRIGHT 2021 SOPREMA



LEVEL 35, BARANGAROO  
AVENUE, SYDNEY, 2000  
WWW.SOPREMA.COM.AU

TITLE: MOVEMENT JOINT DETAIL  
OP1

PROJECT:			DRAWING NUMBER:
SCALE:	NTS	DATE:	2021
			SFC13

**NOTE:**  
This detail is only indicative and should be verified by the designer and/or the applicator according to real job site conditions.

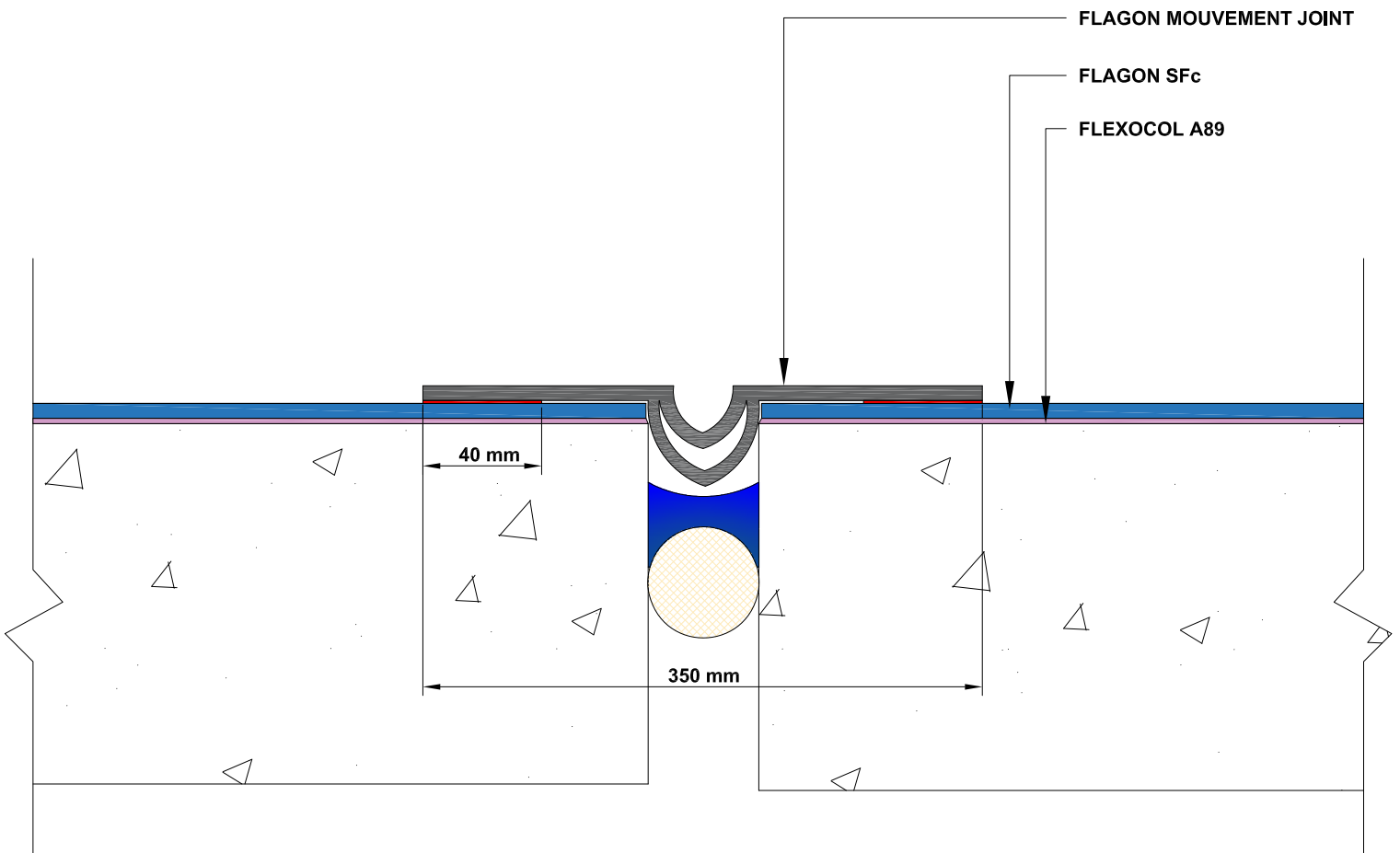

COPYRIGHT 2021 SOPREMA



LEVEL 35, BARANGAROO  
 AVENUE, SYDNEY, 2000  
 WWW.SOPREMA.COM.AU

TITLE:		MOVEMENT JOINT DETAIL OP2	
PROJECT:		DRAWING NUMBER:	
SCALE:	NTS	DATE:	2021
		SFC14	

**NOTE:**  
 This detail is only indicative and should be verified by the designer and/or the applicator according to real job site conditions.

**SIDE LAPS**

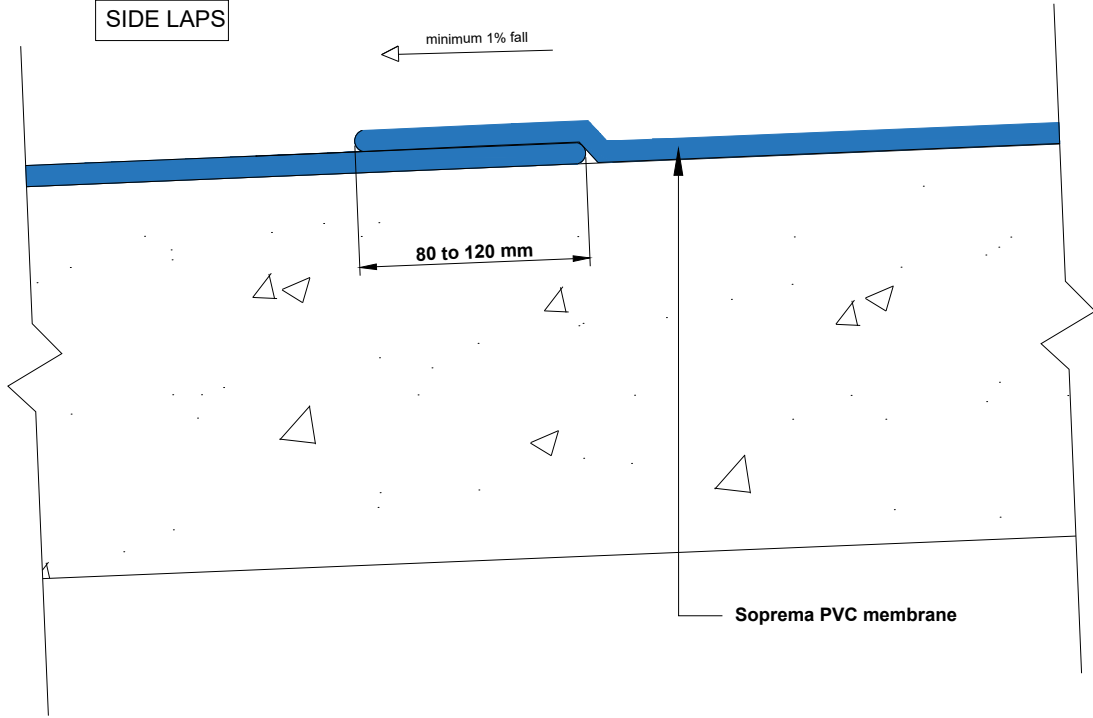

**END LAPS**

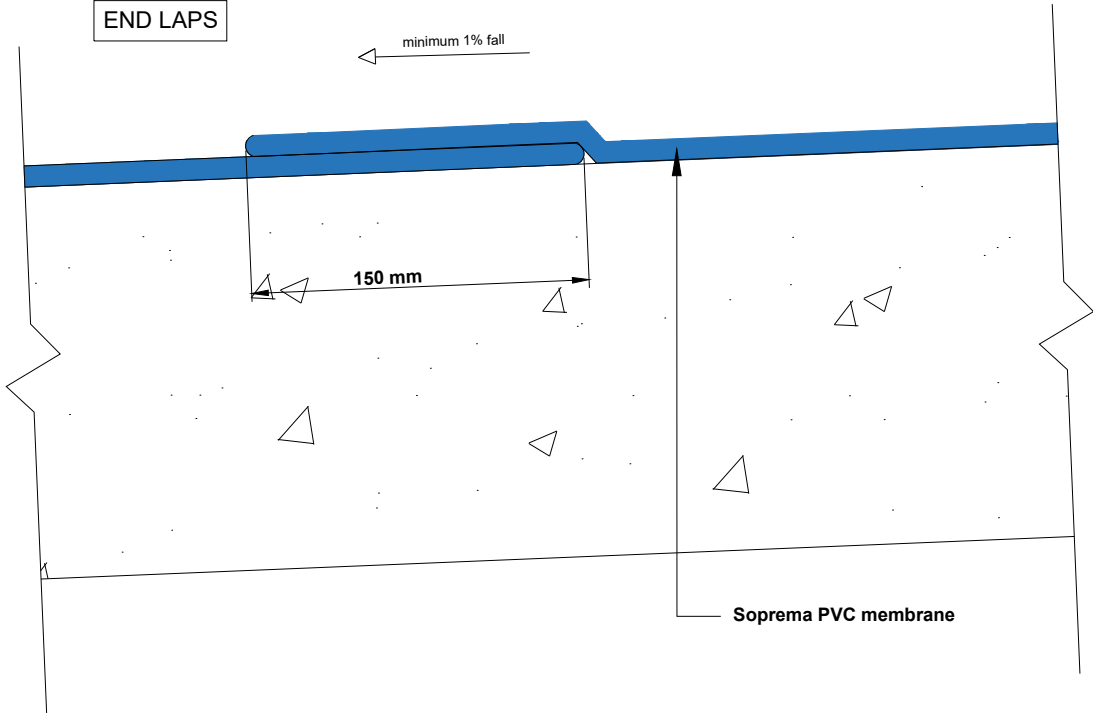

COPYRIGHT 2023 SOPREMA



LEVEL 35, BARANGAROO AVENUE, SYDNEY, 2000  
WWW.SOPREMA.COM.AU

TITLE: <b>OVERLAP DETAIL</b>	
PROJECT:	DRAWING NUMBER: <b>SRW14</b>
SCALE: <b>NTS</b>	DATE: <b>2023</b>

**NOTE:**  
This detail is only indicative and should be verified by the designer and/or the applicator according to real job site conditions.



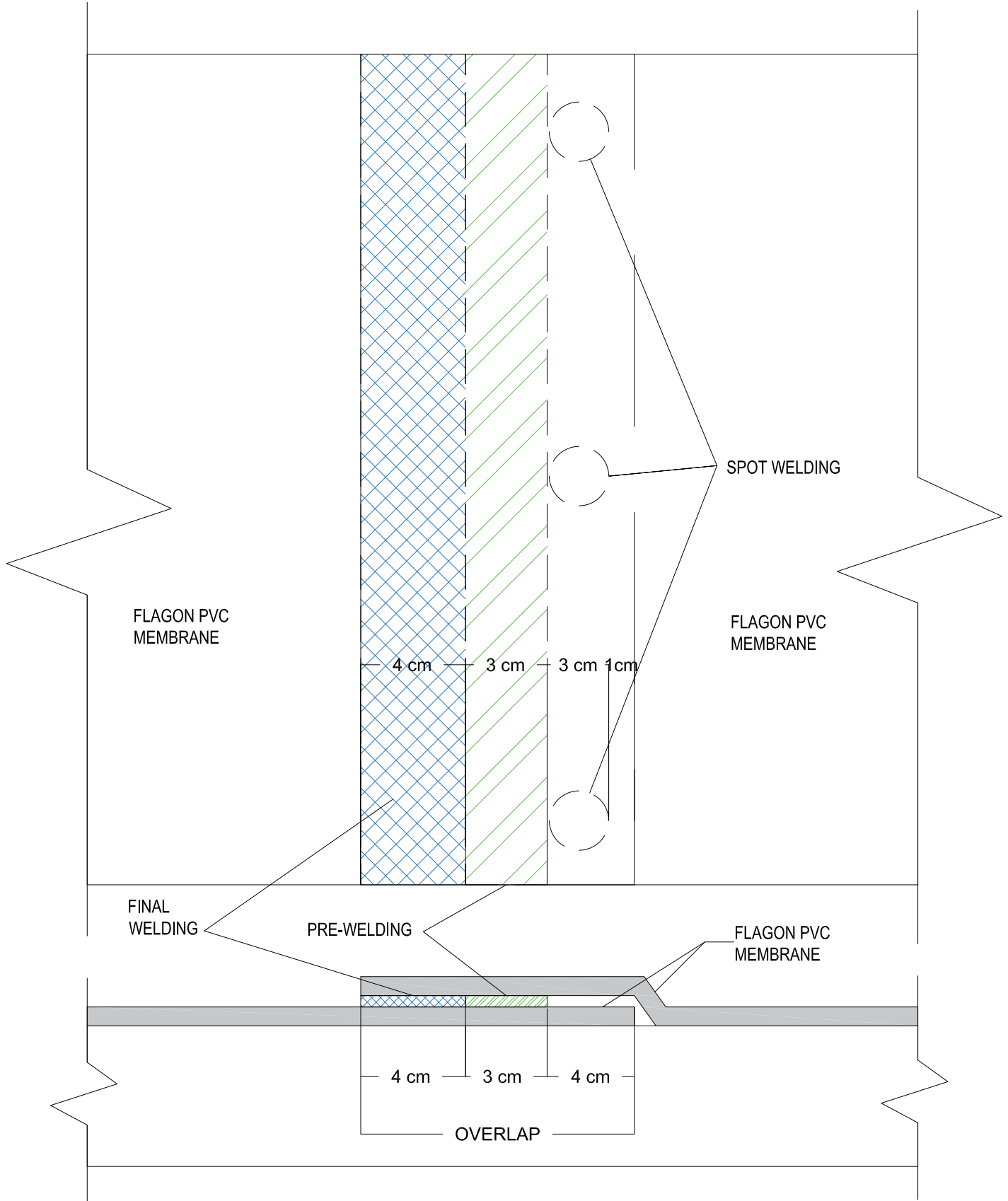

COPYRIGHT 2021 SOPREMA



LEVEL 35, BARANGAROO AVENUE, SYDNEY, 2000  
 WWW.SOPREMA.COM.AU

TITLE: PVC OVERLAP

PROJECT: DRAWING NUMBER:

SCALE: NTS DATE: 2021



SOPREMA's technical team will be more than happy to assist you with any queries you may have. Shall you have any questions, or need assistance with details review for your project, do not hesitate to contact us.

---

**Richard Ajavon**  
**Technical Manager**

[rajavon@soprema.com.au](mailto:rajavon@soprema.com.au)

