

# TECHNICAL DETAILS

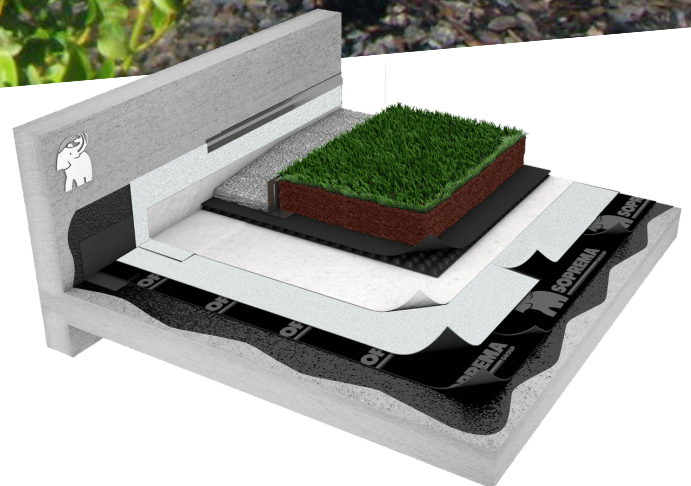

## Bituminous Roofs **TWO-LAYER GREEN ROOF**

[soprema.com.au](http://soprema.com.au)



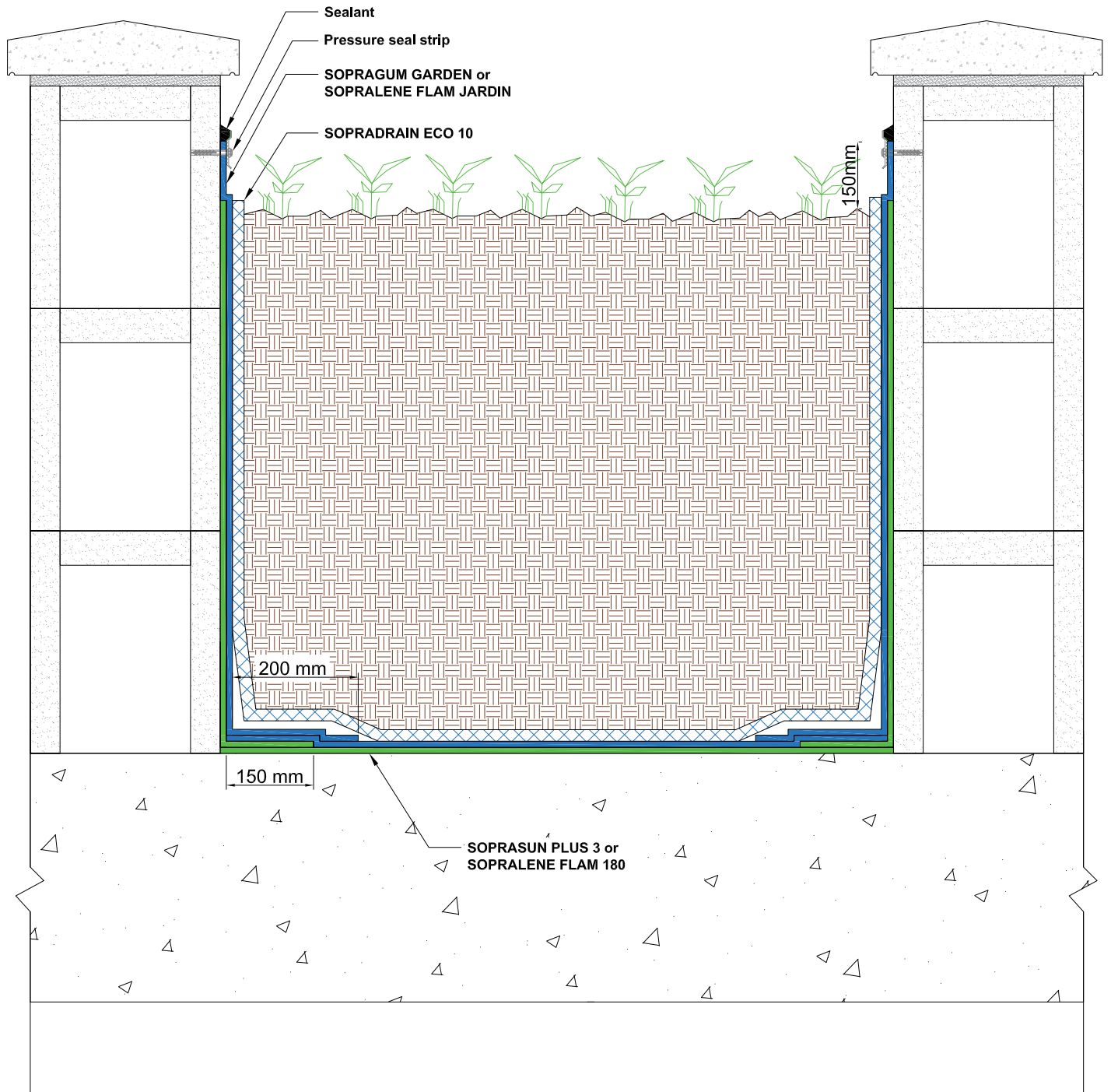

COPYRIGHT 2022 SOPREMA



LEVEL 35, BARANGAROO  
AVENUE, SYDNEY, 2000  
WWW.SOPREMA.COM.AU

TITLE: **PLANTER BOX DETAIL  
BLOCK WALL OR CONCRETE WALL**

PROJECT:			DRAWING NUMBER:
SCALE:	NTS	DATE:	2022
			CW1

**NOTE:**  
This detail is only indicative and should be verified by the designer and/or the applicator according to real job site conditions.

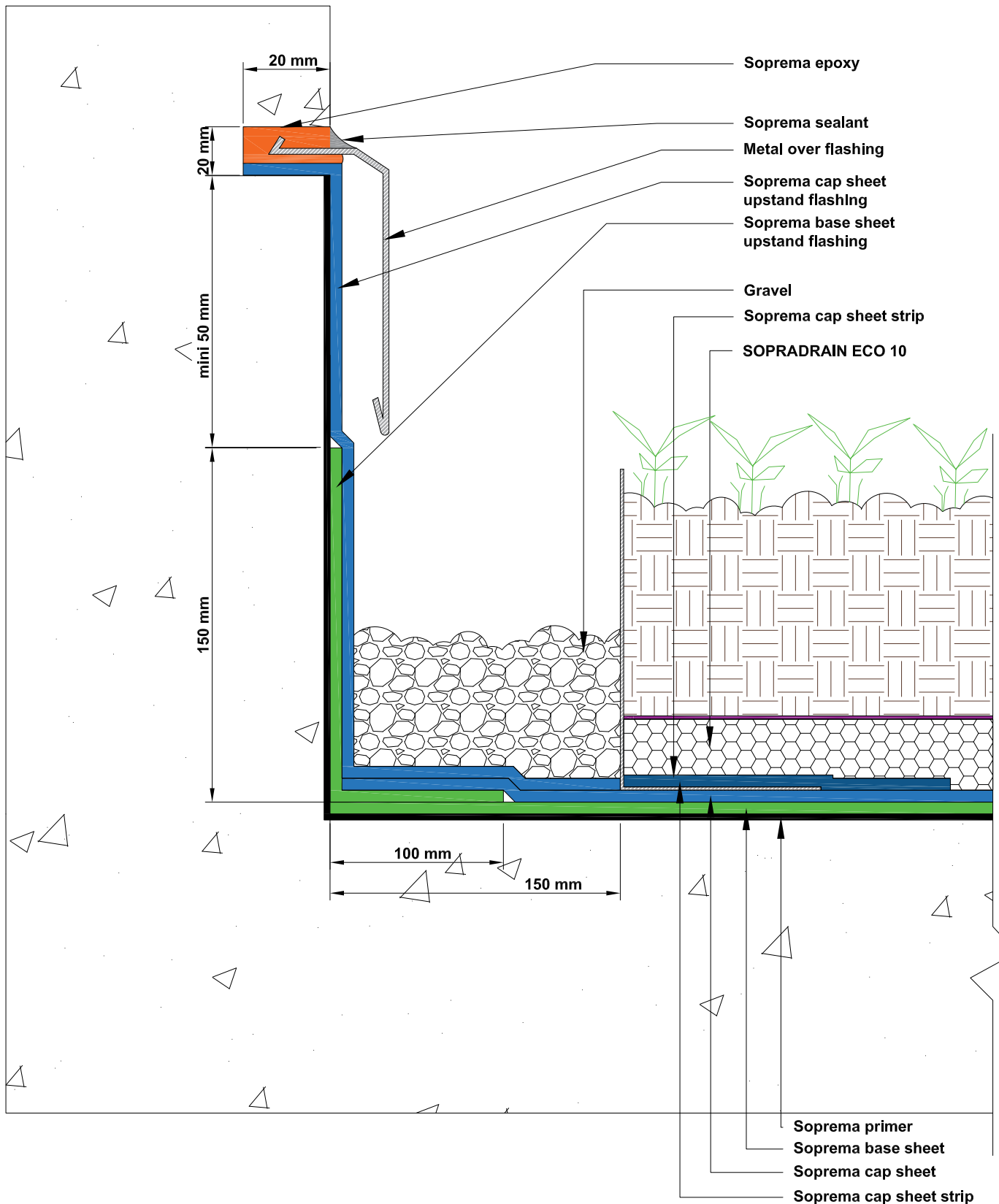

COPYRIGHT 2021 SOPREMA



LEVEL 35, BARANGAROO AVENUE, SYDNEY, 2000  
 WWW.SOPREMA.COM.AU

TITLE: UP-STAND DETAIL WITH TERMINATION INTO A CHASE

PROJECT:		DRAWING NUMBER:	
SCALE:	DATE:	GR5	
NTS	2021		

NOTE:  
 This detail is only indicative and should be verified by the designer and/or the applicator according to real job site conditions.

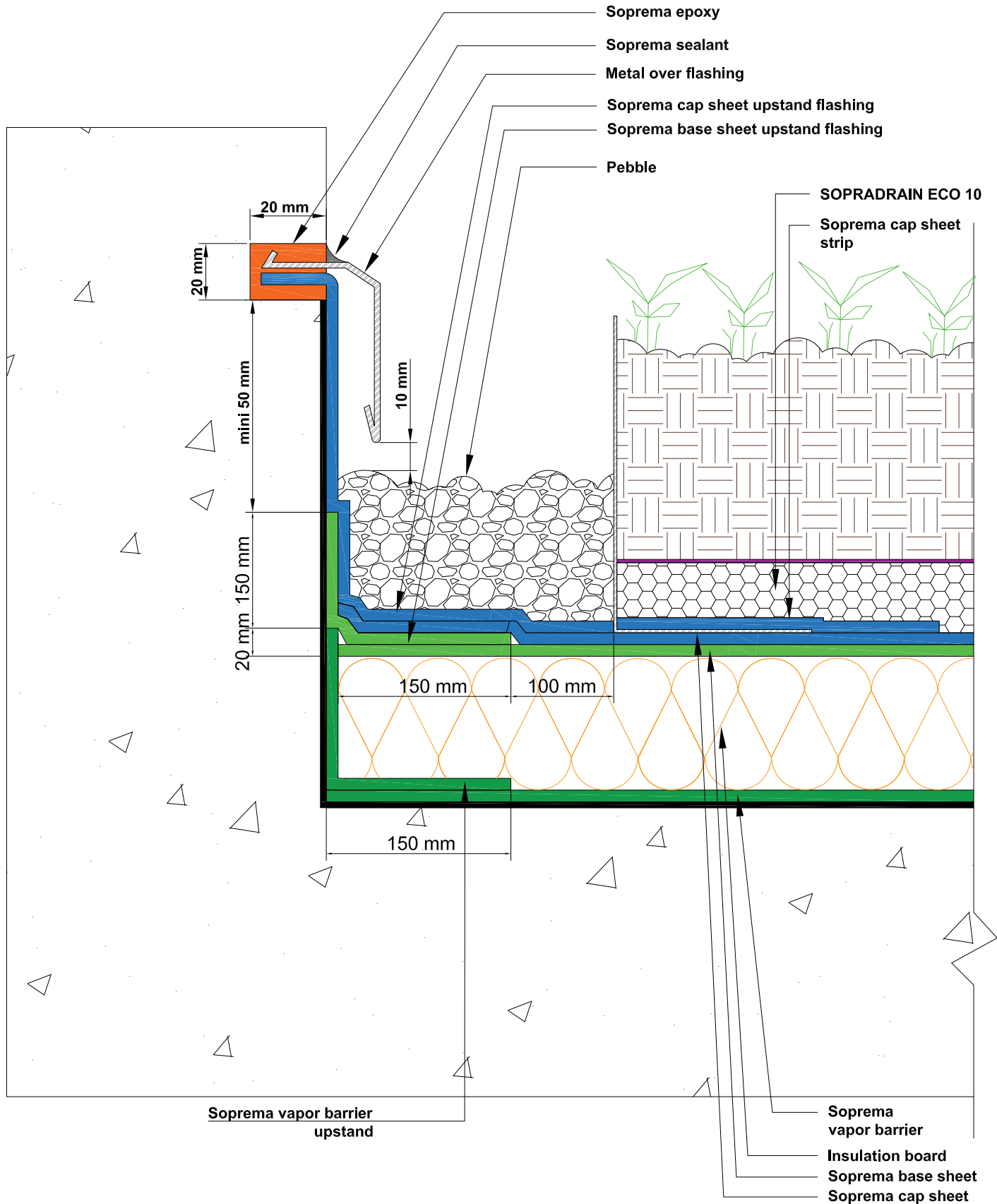

COPYRIGHT 2021 SOPREMA



LEVEL 35, BARANGAROO AVENUE, SYDNEY, 2000  
 WWW.SOPREMA.COM.AU

TITLE: UP-STAND DETAIL WITH TERMINATION INTO A CHASE

PROJECT:			DRAWING NUMBER:
SCALE:	NTS	DATE:	2021
			GWR5

**NOTE:**  
 This detail is only indicative and should be verified by the designer and/or the applicator according to real job site conditions.

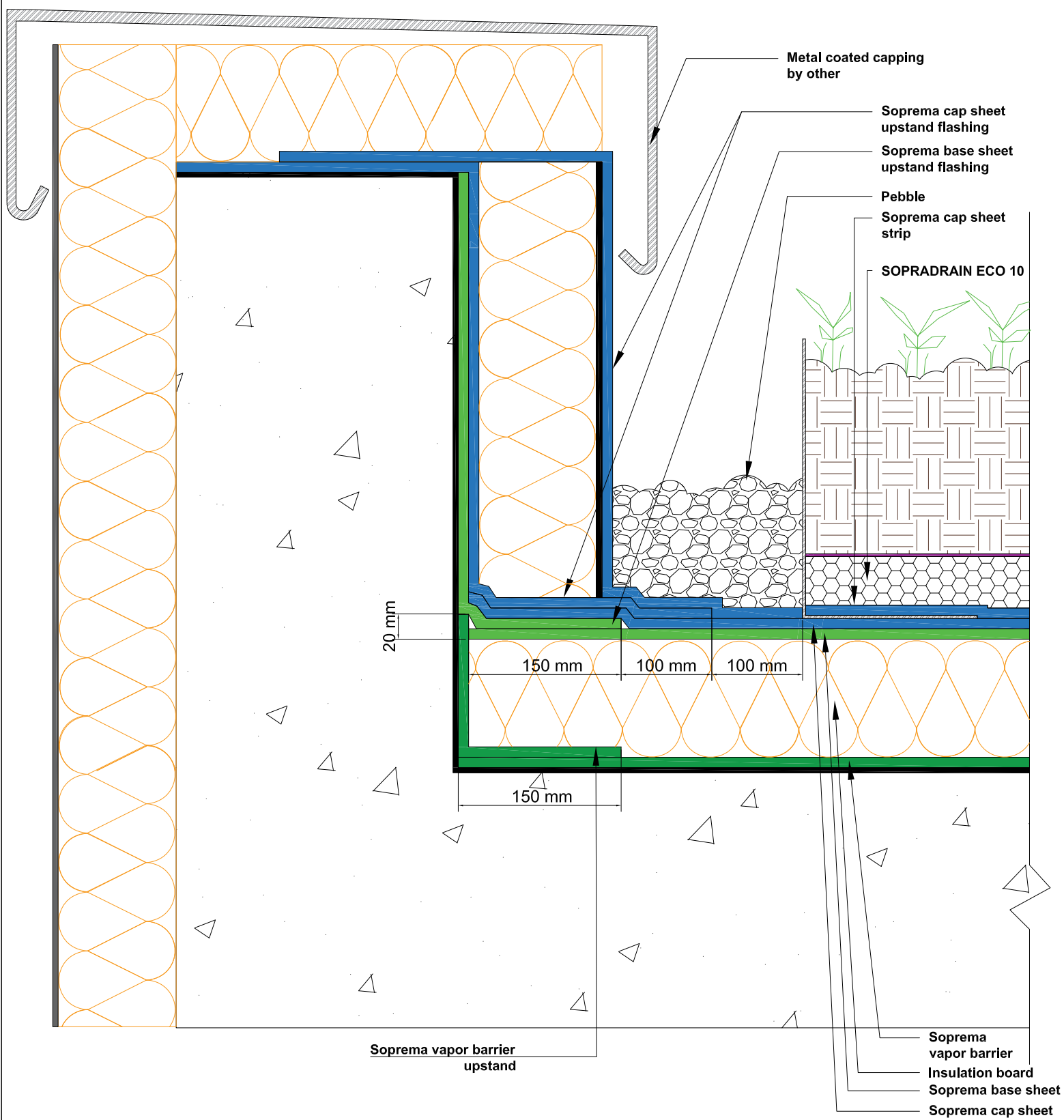

Metal coated capping by other

Soprema cap sheet upstand flashing

Soprema base sheet upstand flashing

Pebble

Soprema cap sheet strip

SOPRADRAIN ECO 10

20 mm

150 mm

100 mm

100 mm

150 mm

Soprema vapor barrier upstand

Soprema vapor barrier

Insulation board

Soprema base sheet

Soprema cap sheet

COPYRIGHT 2021 SOPREMA



LEVEL 35, BARANGAROO AVENUE, SYDNEY, 2000  
WWW.SOPREMA.COM.AU

TITLE: UP-STAND DETAIL WITH CAPPING TERMINATION

PROJECT:			DRAWING NUMBER:
SCALE:	NTS	DATE:	2021
			GWR8

NOTE: This detail is only indicative and should be verified by the designer and/or the applicator according to real job site conditions.

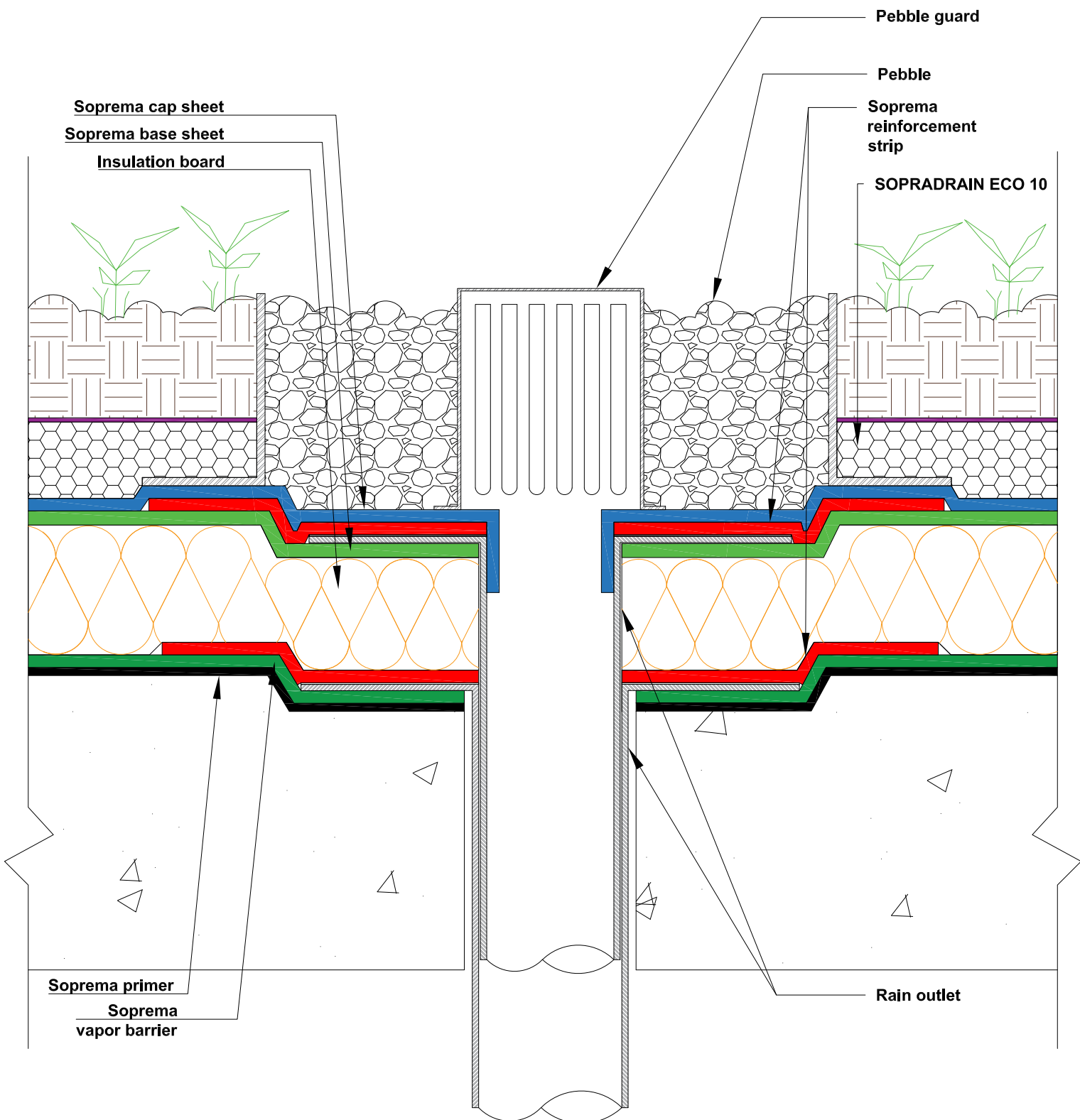

COPYRIGHT 2021 SOPREMA



**SOPREMA**

LEVEL 35, BARANGAROO  
 AVENUE, SYDNEY, 2000  
 WWW.SOPREMA.COM.AU

TITLE: **RAIN OUTLET DETAIL**

PROJECT:

DRAWING NUMBER:

SCALE:

NTS

DATE:

2021

GWR3

**NOTE:**

This detail is only indicative and should be verified by the designer and/or the applicator according to real job site conditions.

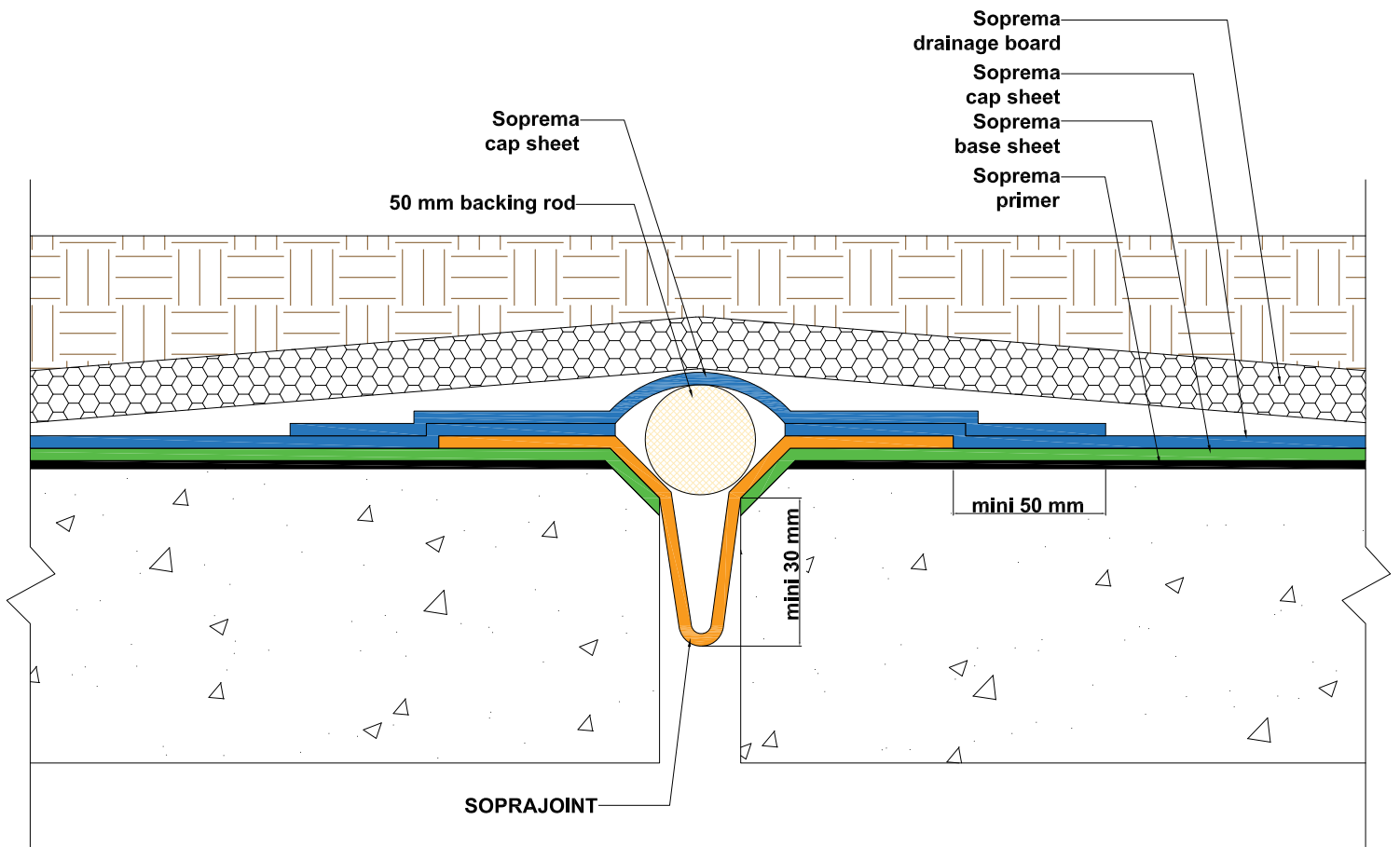

COPYRIGHT 2022 SOPREMA



LEVEL 35, BARANGAROO  
 AVENUE, SYDNEY, 2000  
 WWW.SOPREMA.COM.AU

TITLE: HORIZONTAL MOVEMENT JOINT

PROJECT: DRAWING NUMBER:

SCALE: NTS DATE: 2022

**NOTE:**  
 This detail is only indicative and should be verified by the designer and/or the applicator according to real job site conditions.

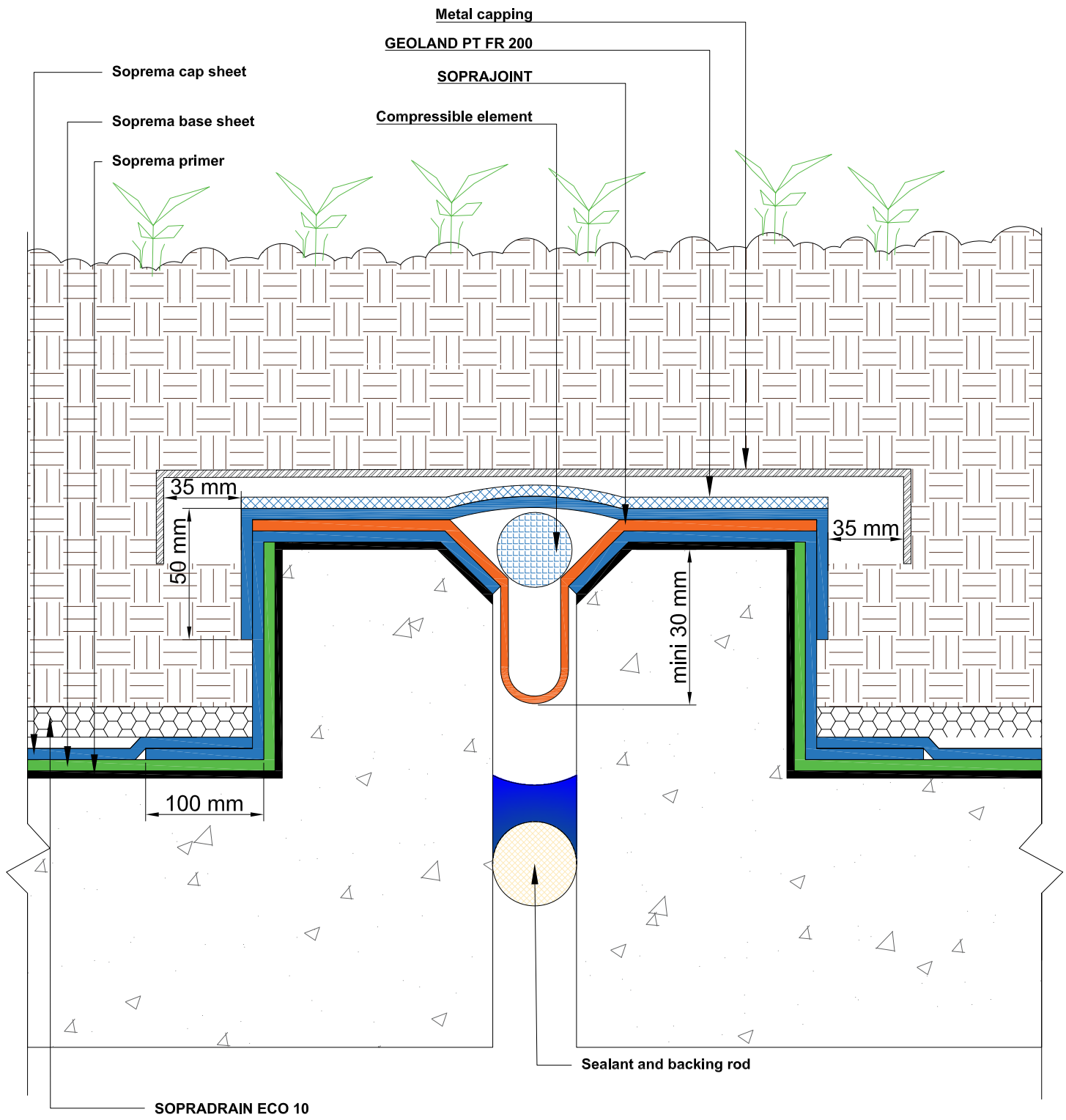

COPYRIGHT 2022 SOPREMA



LEVEL 35, BARANGAROO AVENUE, SYDNEY, 2000  
 WWW.SOPREMA.COM.AU

TITLE: Movement joint detail onto a hob	
PROJECT:	DRAWING NUMBER:
SCALE: NTS	DATE: 2022

**NOTE:**  
 This detail is only indicative and should be verified by the designer and/or the applicator according to real job site conditions.



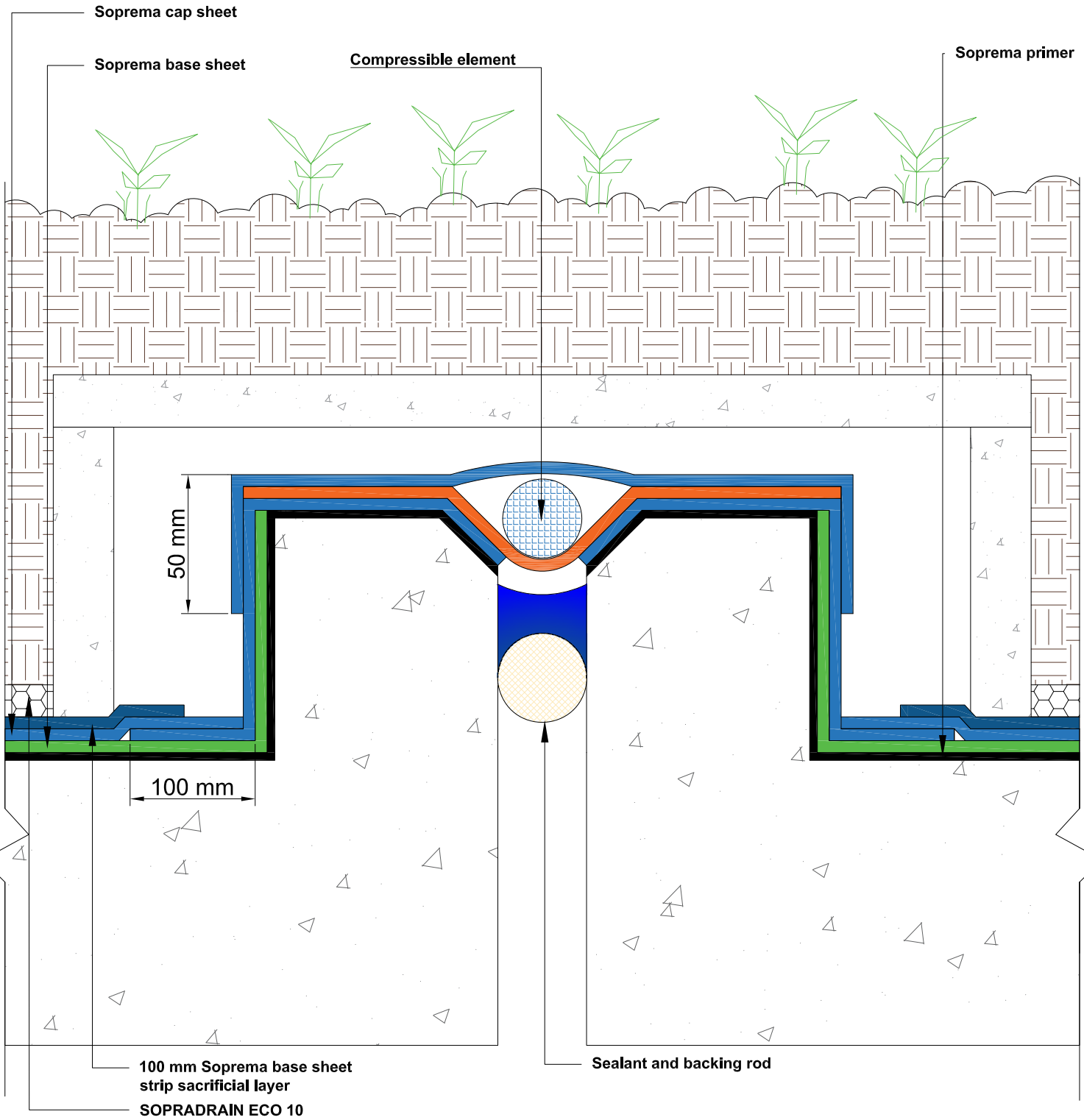

COPYRIGHT 2021 SOPREMA



LEVEL 35, BARANGAROO AVENUE, SYDNEY, 2000  
WWW.SOPREMA.COM.AU

TITLE: MOVEMENT JOINT ONTO A HOB  
DETAIL OP1

PROJECT:			DRAWING NUMBER:
SCALE:	NTS	DATE:	2021
			GR20

**NOTE:**  
This detail is only indicative and should be verified by the designer and/or the applicator according to real job site conditions.



SOPREMA's technical team will be more than happy to assist you with any queries you may have. Shall you have any questions, or need assistance with details review for your project, do not hesitate to contact us.

---

**Richard Ajavon**  
**Technical Manager**

[rajavon@soprema.com.au](mailto:rajavon@soprema.com.au)

