

WP805 Waterproofing Cracks and Control Joints

Preparation:

1. All surfaces to be waterproofed must be firm, clean, dry, sound and smooth. All grease, oil, wax, curing compounds, loose material, paint and any other contaminants must be removed, masonry surfaces must be pointed flush and surface defects repaired. New concrete must be cured for a minimum of 28 days.

Installation:

1. Waterproofing installation shall be in accordance with AS 3740 Waterproofing of Domestic Wet Areas or AS 4654.2 Waterproofing Membranes for External Above-Ground Use.

Tiling installation shall be in accordance with AS 3958.1 Ceramic Tiles - Guide to the Installation of Ceramic Tiles.

2. Square cut the crack or the control joint to a minimum depth of 15mm and width of 10mm. NOTE: Sealants require straight sides to adhere properly, do not V cut.

3. Install a **Closed Cell Backer Rod** and cover with **WPA MS** or **WPA SPUR**.

Closed Cell Backer Rod is a compressible, closed cell polyolefin foam tube with an outer skin. It is used as a backing for cold applied sealants in expansion / construction joints and building seal applications.

WPA MS is a single component, moisture cured silane modified hybrid sealant.

WPA SPUR is a high quality, professional, universal, low modulus sealant based on hybrid technology.

4. Apply **WPA 460** or **WPA 560** primer to the substrate being waterproofed.

WPA 460 is a two-part, water-based epoxy primer, used to seal concrete and masonry surfaces.

WPA 560 is a two-part, water-based epoxy primer, designed as a water and vapour proof coating under waterproofing membranes.

5. Apply **WPA 200**, **WPA 230UV**, **WPA 400**, **WPA 500** or **WPA Rapid** membrane in a minimum of two coats to achieve the required dry film thickness. Ensure that the previous coat has completely dried before applying the subsequent coat(s). NOTE: All penetrations must be waterproofed.

WPA 200 is a flexible, two-part, rapid drying, cementitious waterproofing membrane system, specifically designed for use under tile, stone and exposed applications.

WPA 230UV is an elastomeric, fibre reinforced, water-based polyurethane membrane system designed for exposed or under tile applications.

WPA 400 is an elastomeric, fibre reinforced waterproofing membrane based on high performance polymer technology designed for use under tile finishes.

WPA 500 is a waterborne, fibre reinforced, flexible waterproof membrane designed for use under tile finishes.

WPA Rapid is a fast curing, waterborne flexible waterproof membrane designed for use under tile finishes.

6. All transitions must be detailed utilising **WPA Elastoband**. Ensure **WPA Elastoband** is centred over the crack or the control joint.

WPA Elastoband is an innovative detailing system designed for waterproofing and sealing all types of joints, junctions and transitions subjected to movement.

7. If tiling is required, continue with the following steps.

8. Install tiles using **TPA 401M**, **TPA 501R** or **TPA Lite** tile adhesive.

TPA 401M is a white, flexible, powdered adhesive for wall and floor applications.

TPA 501R is a cost effective, high coverage, flexible, powdered adhesive for wall and floor applications.

TPA Lite is a premium grade, white, fibre reinforced, flexible cement based tile adhesive, based on a light weight formulation.

9. Grout tiles using **TPA Tru Colour Grout** or approved alternative.

TPA Tru Colour Grout is a high-performance stain & efflorescence resistant grout. It is designed for use with most types of Ceramic, Mosaic, Natural Stone and Glass Tiles.

10. Install backing rod to all perimeter and intermediate movement joints and seal with **TPA Tru Colour Sanitary Silicone** or approved alternative.

TPA Tru Colour Sanitary Silicone is a mould resistant, non-diluted, high performance, UV resistant, neutral cure silicone sealant.

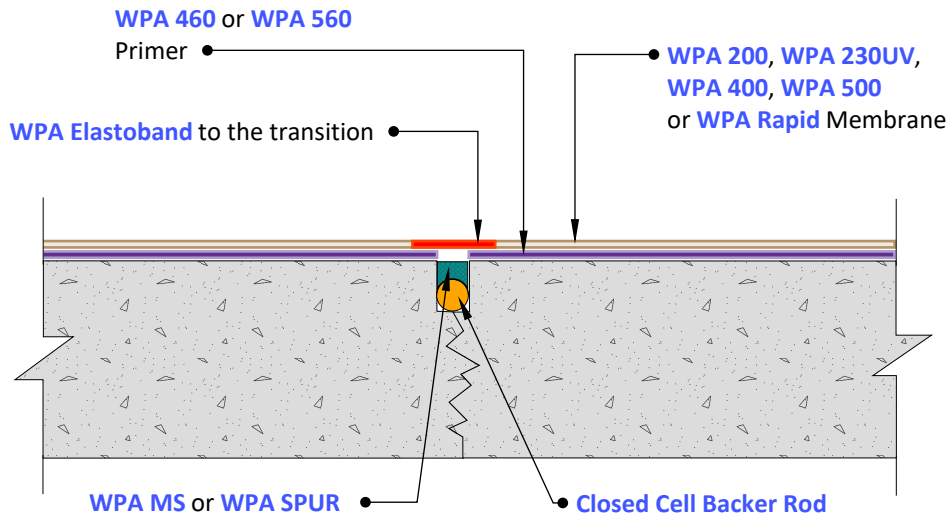

1A Crack Detail - Exposed
Scale: NTS

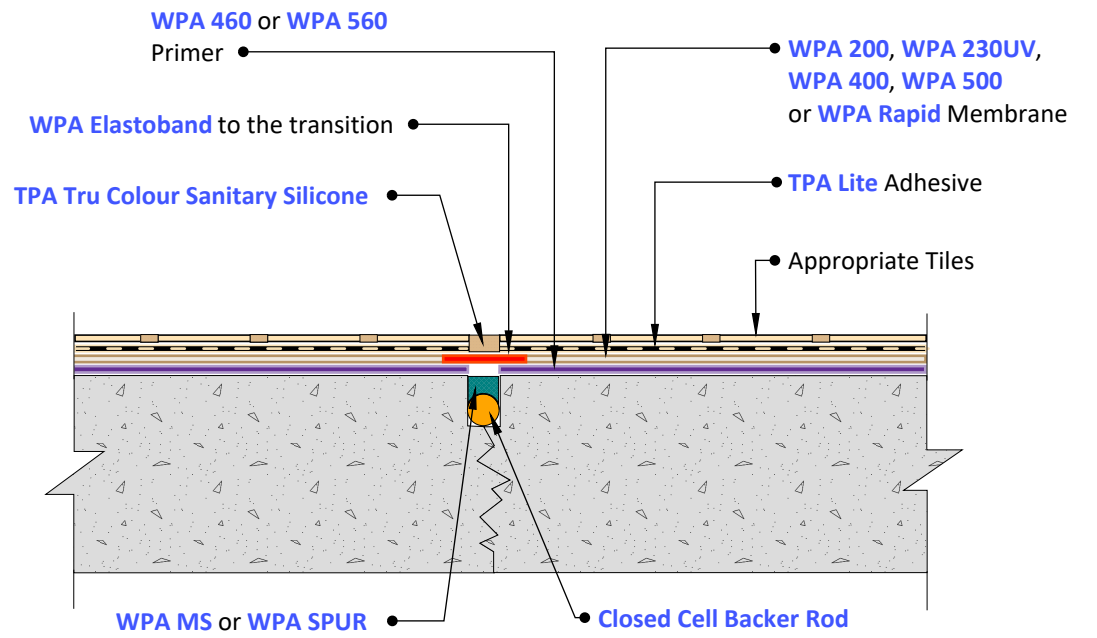

1B Crack Detail - Tiled
Scale: NTS

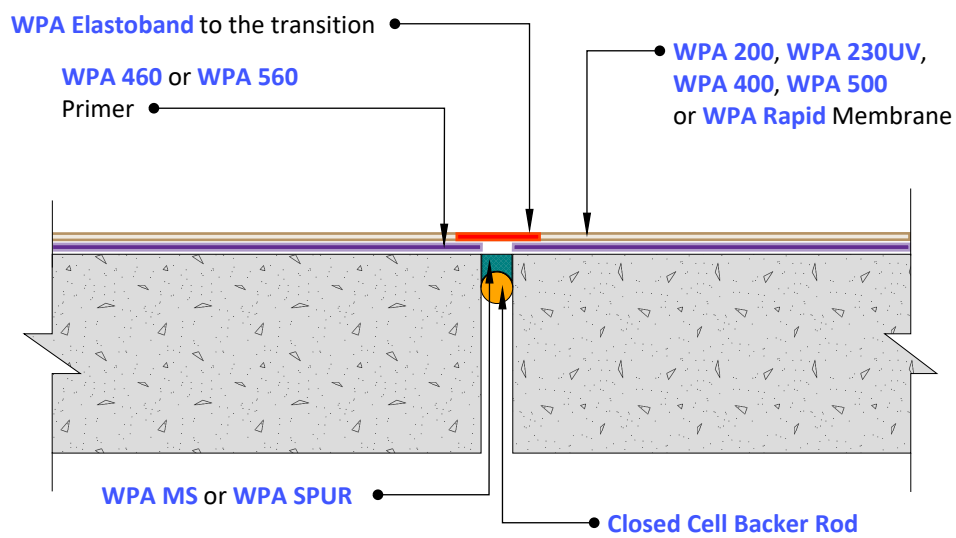

2A Control Joint Detail - Exposed
Scale: NTS

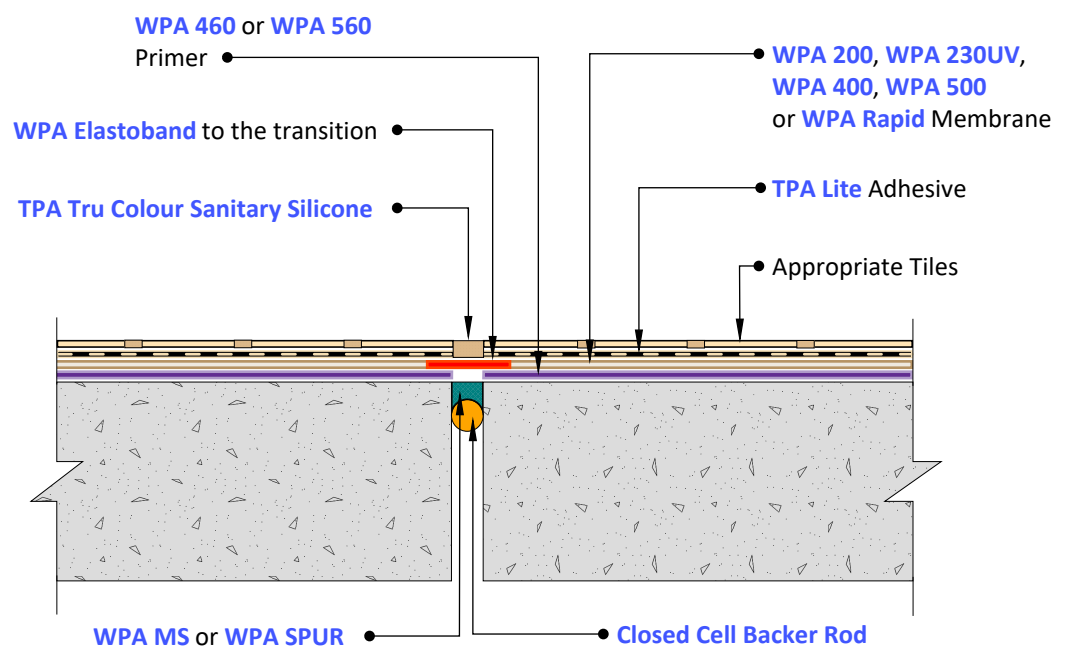

2B Control Joint Detail - Tiled
Scale: NTS

© COPYRIGHT BAYSET PTY LTD

ANY FORM OF REPRODUCTION OF THIS DRAWING IN FULL OR IN PART WITHOUT THE WRITTEN PERMISSION OF BAYSET PTY LTD CONSTITUTES AN INFRINGEMENT OF COPYRIGHT



Waterproofing Cracks and Control Joints

DRAWING NUMBER

WP805

SCALE: NTS

RELEASE: November 29, 2023

DRAWN BY: CS