

# WP800 Waterproofing Window and Door Reveals

## Preparation:

1. All surfaces to be waterproofed must be firm, clean, dry, sound and smooth. All grease, oil, wax, curing compounds, loose material, paint and any other contaminants must be removed, masonry surfaces must be pointed flush and surface defects repaired. New concrete must be cured for a minimum of 28 days.
2. External corners to be waterproofed must be bevelled to ensure a smooth transition of membrane from vertical to horizontal surfaces.

## Installation:

1. Repair all surface defects on masonry surfaces with an appropriate repair mortar.
2. Install an appropriate fillet (bond breaker) to all internal corners using [WPA MS](#), [WPA SPUR](#) or [Admil Supaseal Hybrid PU](#).

[WPA MS](#) is a single component, moisture cured silane modified hybrid sealant.

[WPA SPUR](#) is a high quality, professional, universal, low modulus sealant based on hybrid technology.

[Admil Supaseal Hybrid PU](#) is a Low Modulus, Hybrid Polyurethane, flexible joint sealant and adhesive that is free of Isocyanates and other hazardous raw materials and omits low odour.

3. Apply [WPA 460](#) or [WPA 560](#) primer to substrate to be waterproofed.

[WPA 460](#) is a two-part, water-based epoxy primer, used to seal concrete and masonry surfaces.

[WPA 560](#) is a two-part, water-based epoxy primer, designed as a water and vapour proof coating under waterproofing membranes.

4. Apply [WPA 230UV](#) membrane in a minimum of two coats of to achieve the required dry film thickness. Ensure that the previous coat has completely dried before applying the subsequent coat(s).

[WPA 230UV](#) is an elastomeric, fibre reinforced, water-based polyurethane membrane system designed for exposed or under tile applications.

5. Allow the membrane to fully cure before installing the window system.

6. Seal the window system using [WPA SPUR](#) or [Admil Supaseal Hybrid PU](#).

[WPA SPUR](#) is a high quality, professional, universal, low modulus sealant based on hybrid technology.

[Admil Supaseal Hybrid PU](#) is a Low Modulus, Hybrid Polyurethane, flexible joint sealant and adhesive that is free of Isocyanates and other hazardous raw materials and omits low odour.

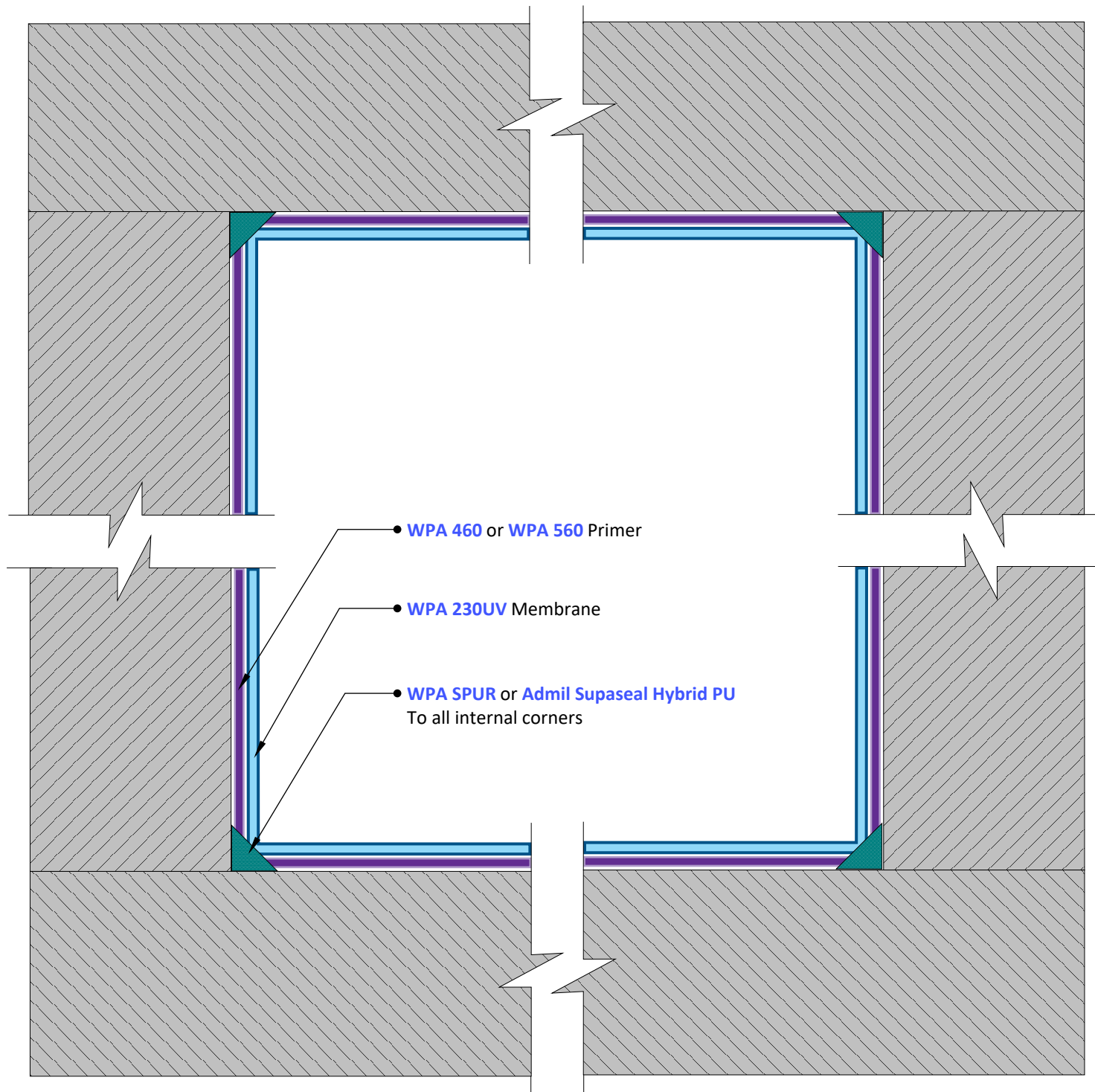

1 Window Detail  
Scale: NTS

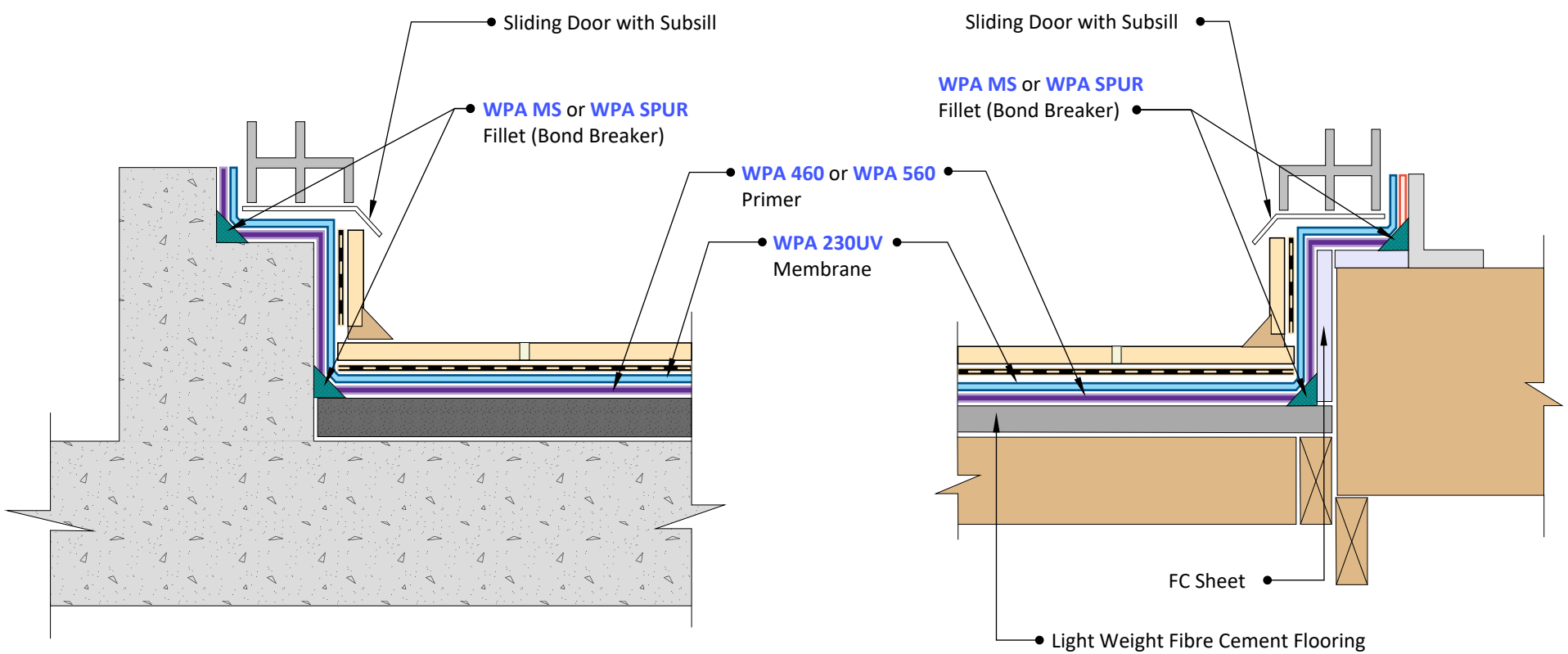

2A Sliding Door Detail  
Scale: NTS

2B Sliding Door Detail  
Scale: NTS

© COPYRIGHT BAYSET PTY LTD  
ANY FORM OF REPRODUCTION OF THIS DRAWING IN FULL OR IN PART WITHOUT THE WRITTEN PERMISSION OF BAYSET PTY LTD CONSTITUTES AN INFRINGEMENT OF COPYRIGHT



## Waterproofing Window and Door Reveals

DRAWING NUMBER

**WP800**

SCALE: NTS

RELEASE: November 29, 2023

DRAWN BY: CS